

EAST WATERLINE RELOCATION PLAN

RECORD DRAWING:
AS BUILT INFORMATION
PER TIGER CONSTRUCTION

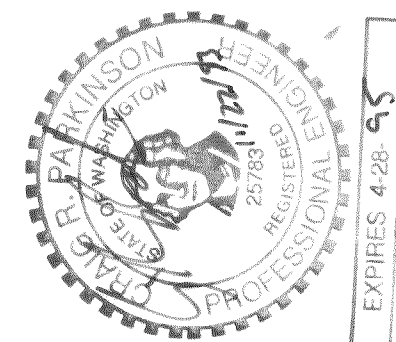

GENERAL NOTES

ALL WORK AND MATERIALS SHALL CONFORM TO AWWA STANDARDS, THE 1991 EDITION OF THE STANDARD SPECIFICATIONS FOR ROAD, BRIDGE AND MUNICIPAL CONSTRUCTION AND SUPPLEMENT (APWA), AS PREPARED BY THE WASHINGTON STATE DEPARTMENT OF TRANSPORTATION AND THE WASHINGTON STATE CHAPTER OF THE AMERICAN PUBLIC WORKS ASSOCIATION, AND SHALL BE SUBJECT TO APPROVAL BY THE CITY OF FERNDALE.

WORK WITHIN THE RIGHT OF WAY OR AFFECTING CITY OF FERNDALE
SERVICES SHALL BE COORDINATED WITH THE CITY OF FERNDALE
DEPARTMENT OF PUBLIC WORKS.

THE CONTRACTOR SHALL CONTACT UTILITIES SERVING THE PROJECT AREA 48 HOURS IN ADVANCE OF THE WORK.

THE CONTRACTOR SHALL PROVIDE HORIZONTAL CONTROL FOR ALIGNMENT.
THE WATER MAINS SHALL BE PLACED IN A COMMON TRENCH WITH A MINIMUM
24 INCH SEPARATION. MINIMUM DEPTH OF COVER SHALL BE 36 INCHES.

ALL PIPE SHALL BE BEDDED IN ACCORDANCE WITH APWA SPECIFICATION 7-10.3(9)B. PIPE BEDDING SHALL CONFORM TO APWA SPECIFICATION 9-03.16.

ALL FITTINGS SHALL HAVE A MINIMUM PRESSURE RATING OF 350 PSI.
MECHANICAL JOINT FITTINGS SHALL BE AWWA C153 DUCTILE IRON.
FLANGED FITTINGS SHALL BE DUCTILE IRON AND SHALL BE SHORT BODY
CLASS 125 FLANGES.

CONCRETE THRUST BLOCKING SHALL BE PLACED AT ALL BENDS, TEES, VALVES, AND OTHER FITTINGS INSTALLED OR RELOCATED. THRUST BLOCKING SHALL BE CEMENT CONCRETE POURED IN PLACE. CONCRETE THRUST BLOCKING SHALL BEAR AGAINST SOLID UNDISTURBED EARTH AT THE SIDES AND BOTTOM OF THE TRENCH EXCAVATION AND SHALL BE SHAPED TO NOT OBSTRUCT ACCESS TO THE JOINTS OF THE PIPE OR FITTINGS. ALL EXISTING WATER SERVICES SHALL BE REPLACED IN KIND.

THE CONTRACTOR SHALL MARK ALL UNDERGROUND WATER MAINS WITH A 2 INCH DETECTABLE METALIZED TAPE. SAID TAPE SHALL BE BRIGHTLY COLORED AND BEAR AN IMPRINT IDENTIFYING THE TYPE OF LINE BURIED BELOW. THE DETECTOR TAPE SHALL BE BURIED 12 INCHES TO 18 INCHES ABOVE EACH WATER MAIN.

THE CONTRACTOR SHALL PRESSURE TEST WATER MAIN IN ACCORDANCE WITH APWA SPECIFICATION 7-11.3(11). ALL WATER LINE SHALL BE PRESSURE TESTED AT 200 PSI.

THE CONTRACTOR SHALL DISINFECT AND FLUSH WATER MAIN IN ACCORDANCE WITH APWA SPECIFICATION 7-11.3(12).

THE CONTRACTOR SHALL PROVIDE THE ENGINEER WITH "AS-BUILT" PRINTS. ALIGNMENT OF THE WATER MAIN, VALVES, WATER SERVICES, AND CROSSINGS OF OTHER UTILITIES SHALL BE NOTED ON THE "AS-BUILT" PRINT. MEASUREMENTS TO THE WATER MAIN, AND UTILITY CROSSINGS SHALL BE TAKEN FROM EXISTING MONUMENTS, MANHOLE COVERS, PROPERTY CORNERS, ETC..

THE CONTRACTOR SHALL RESTORE ALL LAWNS, FENCES, GRAVEL, ASPHALT, AND CONCRETE DRIVEWAYS, ROADS, ETC., TOGETHER WITH ALL OTHER SURFACE AND SUBSURFACE IMPROVEMENTS THAT ARE AFFECTED BY THE RELOCATION OF THE WATER MAINS ON BOTH PUBLIC AND PRIVATE PROPERTY WITHIN A THREE WEEK PERIOD AFTER THE INITIAL DISTURBANCE.

TEMPORARY CONNECTION TO THE EXISTING WATER MAINS, IF NECESSARY, SHALL BE MADE WITH CROSS CONNECTION DEVICES IN ACCORDANCE WITH APWA SPECIFICATION 7-11.3(12)J.

THE FOLLOWING ADDITIONAL SPECIFIC REQUIREMENTS SHALL BE MET FOR EACH WATERLINE RELOCATION:

NORTH STAR WATER ASSOCIATION REQUIREMENTS

1. ALL PIPE FOR WATER MAIN SHALL BE 8" 200 PSI PVC SDR 21 AND SHALL CONFORM TO ASTM D2241 SPECIFICATIONS. RUBBER RINGS SHALL CONFORM TO ASTM F 477.
2. THE CONTRACTOR SHALL CONTACT RAY BLOOMQUIST, (206) 384-3230, JUDY HEIDT, (206) 380-1150, AND ROBERT FROST, (206) 384-3133 OR 384-1472, 48 HOURS PRIOR TO DISRUPTION OF SERVICE. A REPRESENTATIVE OF THE NORTH STAR WATER ASSOCIATION SHALL BE INVITED TO OBSERVE ALL WORK RELATED TO RELOCATION, PRESSURE TESTING, AND DISINFECTION OF THEIR WATER MAIN.
3. DISRUPTION OF SERVICE SHALL BE RESTRICTED TO THE HOURS BETWEEN 10:30 AM AND 4:00 PM.

THORNTON ROAD WATER ASSOCIATION REQUIREMENTS

1. ALL PIPE FOR WATER MAIN SHALL BE "4" 200 PSI PVC SDR 21 AND SHALL CONFORM TO ASTM D2241 SPECIFICATIONS. RUBBER RINGS SHALL CONFORM TO ASTM F 477.
2. THE CONTRACTOR SHALL CONTACT LARRY BLOOMQUIST, (206) 384-7392, TIM BLOOMQUIST, (206) 384-0734, AND DAVE SCHWEIGERT, (206) 384-4151, 48 HOURS PRIOR TO DISRUPTION OF SERVICE. A REPRESENTATIVE OF THE THORNTON ROAD WATER ASSOCIATION SHALL BE INVITED TO OBSERVE ALL WORK RELATED TO THE RELOCATION, PRESSURE TESTING, AND DISINFECTION OF THEIR WATER MAIN.
3. DISRUPTION OF SERVICE SHALL BE RESTRICTED TO THE HOURS BETWEEN 10:30 AM AND 4:00 PM.

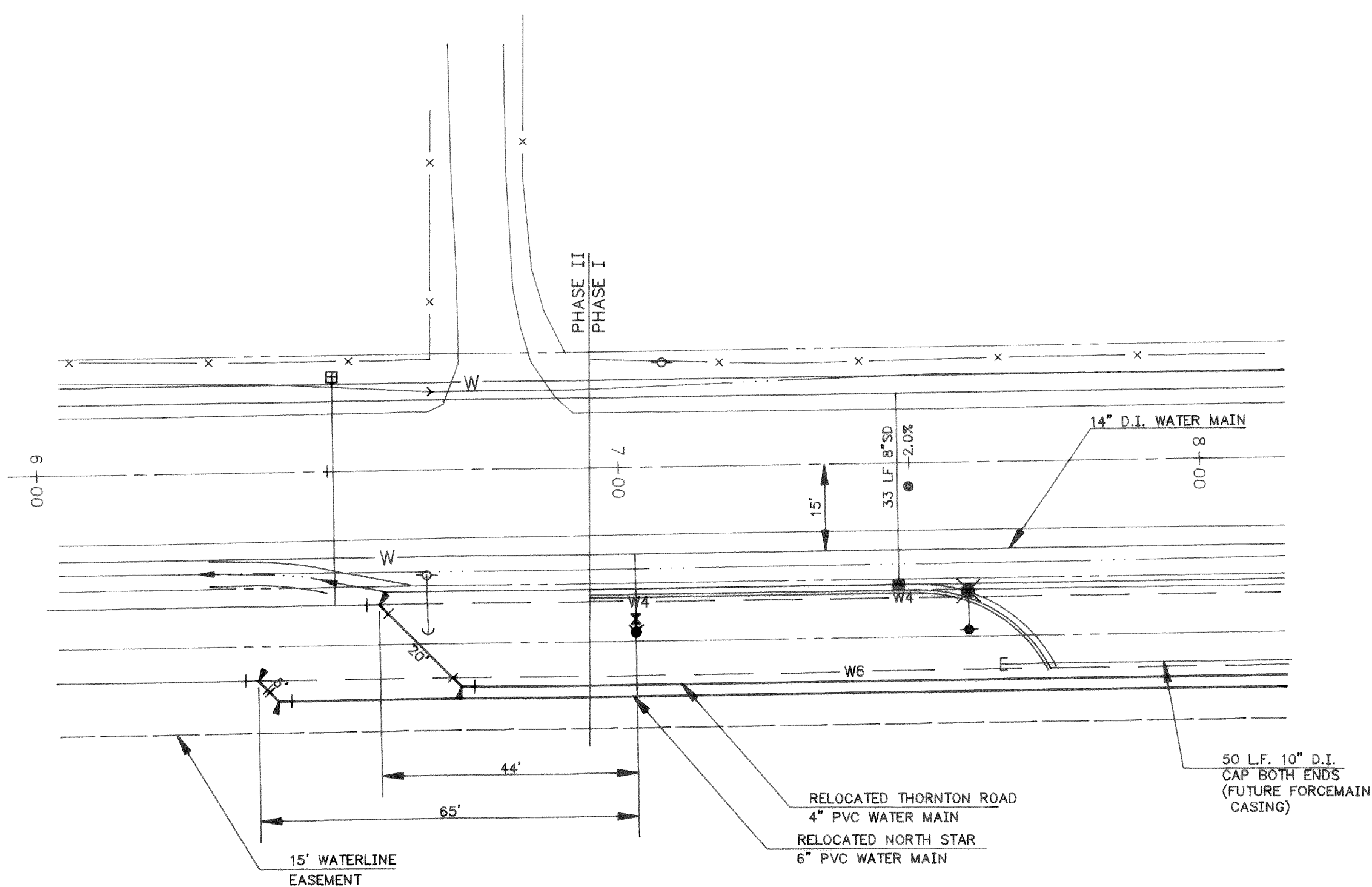

WEST WATERLINE RELOCATION PLAN

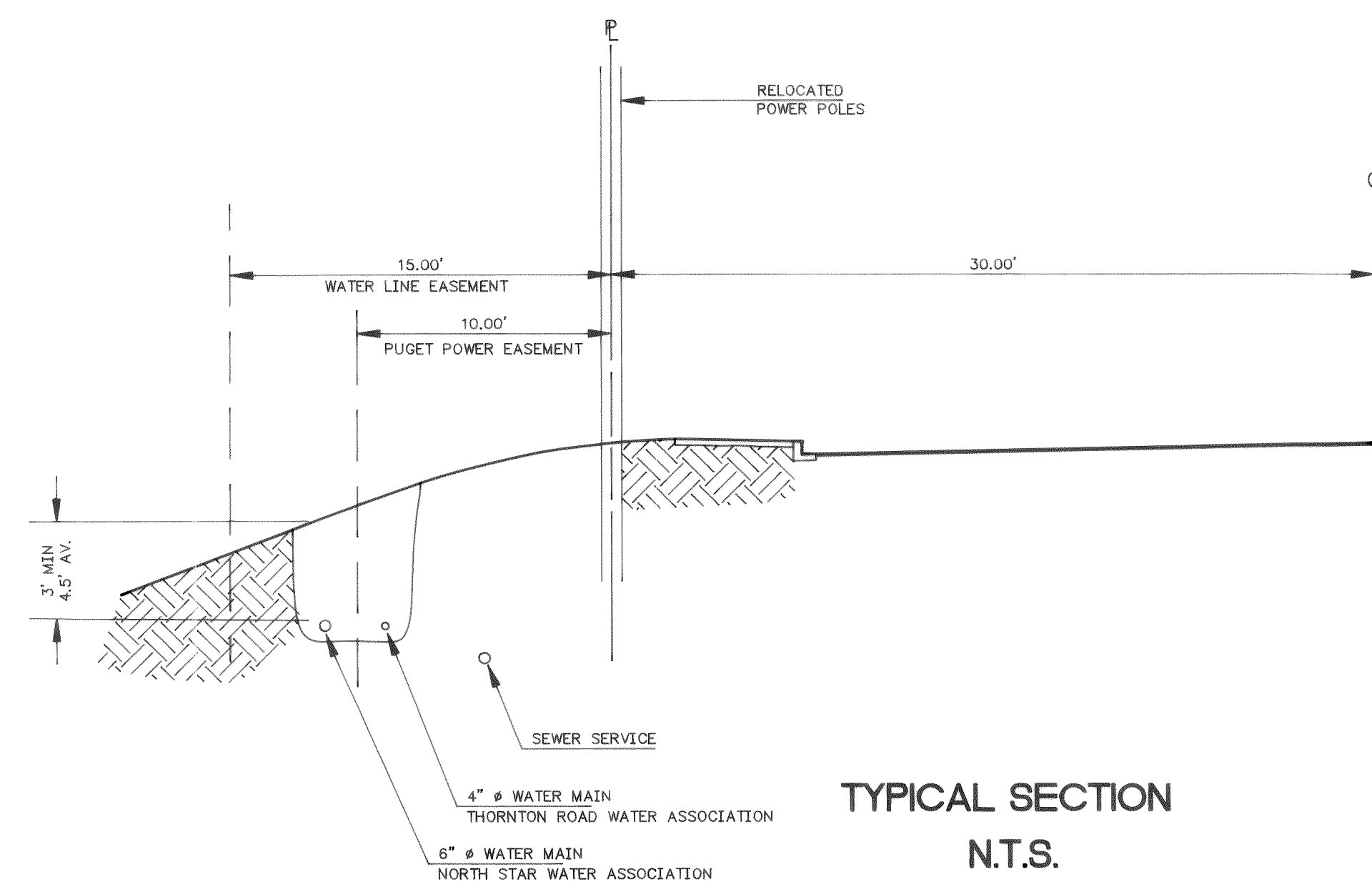

TYPICAL SECTION
N.T.S.