

15-107 121819 PACIFIC FERN POND RECORD DRAWING (TM.dwg) Jan 07, 2020 - 4:00pm FULL SIZE SHEET IS 24"X36" / REDUCED COPIES 11"X17"

PACIFIC FERN BUSINESS PARK

STREET AND STORMWATER POND IMPROVEMENTS

GENERAL NOTES:

- PRIOR TO STARTING CONSTRUCTION THE CONTRACTOR SHALL BE RESPONSIBLE TO MAKE SURE THAT ALL REQUIRED PERMITS AND APPROVALS HAVE BEEN OBTAINED. NO CONSTRUCTION OR FABRICATION SHALL BEGIN UNTIL THE CONTRACTOR HAS RECEIVED AND THOROUGHLY REVIEWED ALL PLANS AND OTHER DOCUMENTS APPROVED BY ALL OF THE PERMITTING AUTHORITIES. CONTRACTOR SHALL OBTAIN A REVOCABLE ENCROACHMENT PERMIT FROM THE CITY OF FERNDALE PRIOR TO COMMENCING ANY WORK IN THE PUBLIC RIGHT-OF-WAY. THE CONTRACTOR SHALL SCHEDULE A PRE-CONSTRUCTION CONFERENCE WITH THE REPRESENTATIVES FROM THE CITY OF FERNDALE PUBLIC WORKS DEPARTMENT A MINIMUM OF THREE (3) WORKING DAYS PRIOR TO BEGINNING WORK.
- ALL WORK SHALL BE PERFORMED IN ACCORDANCE WITH THESE PLANS AND THE CURRENT WSDOT STANDARD SPECIFICATIONS AND THE REQUIREMENTS OF THE CITY OF FERNDALE DEVELOPMENT AND CONSTRUCTION STANDARDS. IN THE EVENT OF A CONFLICT THE MOST STRINGENT REQUIREMENTS SHALL APPLY.
- ALL WORK AND MATERIALS SHALL BE SUBJECT TO APPROVAL BY THE CITY OF FERNDALE. REPRESENTATIVES FROM THE CITY OF FERNDALE PUBLIC WORKS DEPARTMENT MUST INSPECT ALL WORK. THE CONTRACTOR SHALL CALL AT LEAST 24 HOURS IN ADVANCE TO SCHEDULE INSPECTIONS AS FOLLOWS.
 - PLACEMENT OF TEMPORARY EROSION CONTROL MEASURES.
 - PLACEMENT OF WATER MAIN AND BACK FILLING OF WATER MAIN WITHIN ROAD RIGHT-OF-WAY OR IN WATERLINE EASEMENTS TO BE DEDICATED TO THE CITY OF FERNDALE.
 - PLACEMENT AND BACKFILLING OF UNDERGROUND UTILITIES, STORM SEWER AND SANITARY SEWER WITHIN ROAD RIGHT-OF-WAY OR IN EASEMENTS TO BE DEDICATED TO THE CITY OF FERNDALE.
 - END OF MAINTENANCE PERIOD.
- SITE CLEARING SHALL INCLUDE THE LOCATION AND REMOVAL OF ALL ABOVE GROUND AND BURIED DEBRIS AND WASTE THAT MAY BE PRESENT.
- CONTRACTOR SHALL RESTORE ALL PRIVATE AND PUBLIC PROPERTY DISRUPTED BY THE PROJECT IMMEDIATELY AFTER CONSTRUCTION.
- CONTRACTOR SHALL INFORM THE ENGINEER AND OBTAIN APPROVAL FROM THE CITY OF FERNDALE PUBLIC WORKS DEPARTMENT OF ANY PROPOSED CHANGES IN PLAN PRIOR TO CONSTRUCTION OF THAT CHANGE. CONTRACTOR SHALL KEEP RECORD OF DEVIATIONS AND FORWARD TO THE ENGINEER.
- THE LOCATIONS OF UNDERGROUND FACILITIES SHOWN ON THESE PLANS ARE BASED ON FIELD SURVEYS AND LOCAL UTILITY COMPANY RECORDS. IT SHALL BE THE CONTRACTORS FULL RESPONSIBILITY TO CONTACT THE VARIOUS UTILITY COMPANIES TO LOCATE THEIR FACILITIES PRIOR TO STARTING CONSTRUCTION. NO ADDITIONAL COMPENSATION SHALL BE PAID TO THE CONTRACTOR FOR DAMAGE AND REPAIR TO THESE FACILITIES CAUSED BY HIS WORK FORCE. CALL 1-800-424-5555.
- ALL DIMENSIONS AND GRADES SHOWN ON THE PLANS SHALL BE FIELD VERIFIED BY THE CONTRACTOR PRIOR TO CONSTRUCTION. CONTRACTOR SHALL NOTIFY THE CONSTRUCTION MANAGER IF ANY DISCREPANCIES EXIST PRIOR TO PROCEEDING WITH CONSTRUCTION FOR NECESSARY PLAN OR GRADE CHANGES. NO EXTRA COMPENSATION SHALL BE PAID TO THE CONTRACTOR FOR WORK HAVING TO BE REDONE DUE TO DIMENSIONS OR GRADES SHOWN INCORRECTLY ON THESE PLANS IF SUCH NOTIFICATION HAS NOT BEEN GIVEN.
- THE CONTRACTOR SHALL BE RESPONSIBLE FOR PROVIDING ADEQUATE SAFEGUARDS, SAFETY DEVICES, PROTECTIVE EQUIPMENT, FLAGGERS, AND ANY OTHER NEEDED ACTIONS TO PROTECT THE LIFE, HEALTH AND SAFETY OF THE PUBLIC, AND TO PROTECT PROPERTY IN CONNECTION WITH THE PERFORMANCE OF WORK COVERED BY THE CONTRACTOR. ANY WORK WITHIN THE TRAVELED RIGHT-OF-WAY THAT MAY INTERRUPT NORMAL TRAFFIC FLOW SHALL REQUIRE AT LEAST ONE FLAGGER FOR EACH LANE OF TRAFFIC AFFECTED. ALL SECTIONS OF THE WSDOT STANDARD SPECIFICATIONS 1-07.23(1) - TRAFFIC CONTROL SHALL APPLY.
- ALL DISTURBED AREAS SHALL BE COVERED WITH MULCH OR WOOD CHIPS WHILE NOT UNDER CONSTRUCTION.
- AN APPROVED COPY OF THESE PLANS MUST BE ON-SITE WHENEVER CONSTRUCTION IS IN PROGRESS.

CITY PROJECT NOTES:

THE CITY OF FERNDALE DOES NOT GUARANTEE THAT AS BUILT INFORMATION ON RECORD FOR EXISTING UTILITIES ARE CORRECT. THE CITY REQUIRES THAT THE PROJECT OWNER POTHOLE ALL EXISTING UTILITIES TO AVOID COSTLY DELAYS OR DEVIATIONS FROM YOUR APPROVED PLANS AS PROPOSED. THE CITY OF FERNDALE WILL NOT BE HELD RESPONSIBLE FOR COSTS ASSOCIATED TO THESE DELAYS AND OR DEVIATIONS FROM THE APPROVED PLANS DUE TO INACCURATE INFORMATION.

ALL ROADS, STRUCTURES, CLEARING LIMITS, ETC., WILL BE CLEARLY STAKED BY A LICENSED SURVEYOR OR THE PROJECT ENGINEER BEFORE THE START OF CONSTRUCTION.

ALL CONSTRUCTION TRAFFIC WILL BE ROUTED TO THE DESIGNATED CONSTRUCTION ENTRANCE TO THE NORTH AS PROPOSED. CONSTRUCTION TRAFFIC SOUTH DOWN THE UTILITY ACCESS EASEMENT OR EAST INTO EXISTING PRIVATE BUSINESS AREA WILL BE PROHIBITED WITHOUT PRIOR WRITTEN CONSENT.

LEGEND		
	EXISTING	PROPOSED
LOT LINE	----	----
STREET CENTERLINE	----	----
RIGHT-OF-WAY LINE	----	----
UNDERGROUND POWER	---P---P---	---P---P---
UNDERGROUND TV	---TV---TV---	---TV---TV---
FIBER OPTICS	---FO---FO---	---FO---FO---
UNDERGROUND TELEPHONE	---T---T---	---T---T---
OVERHEAD POWER	---OP---OP---	---OP---OP---
OVERHEAD TELEPHONE	---OT---OT---	---OT---OT---
GAS MAIN	---G---G---	---G---G---
WATER MAIN	---W---W---	---W---W---
SANITARY SEWER MAIN	---S---S---	---SS---SS---
STORM DRAIN	---D---D---	---SD---SD---
DITCH/FLOW LINE	----	----
EDGE OF PAVEMENT	----	----
CURB AND GUTTER	====	====
BUILDING WALL	=====	=====
FENCE	---X---X---	---X---X---
ROCKERY WALL	-----	-----
ELEV. CONTOUR	-----100-----	-----100-----
TREES/VEGETATION		
STORM DRAIN CATCH BASIN		
UTILITY POLE		
STREET/TRAFFIC SIGN		
SAN. SEWER MANHOLE		
SAN. SEWER CLEAN-OUT		
WATER SERVICE METER		
FIRE HYDRANT		

ENGINEER'S CERTIFICATION

I HEREBY CERTIFY THAT THE IMPROVEMENTS FOR PACIFIC FERN BUSINESS PARK HAVE BEEN INSPECTED BY APC ENGINEERS AND TO THE BEST OF MY KNOWLEDGE, HAVE BEEN CONSTRUCTED IN GENERAL CONFORMANCE WITH THE CITY OF FERNDALE DEVELOPMENT STANDARDS, THE CITY OF FERNDALE MUNICIPAL CODE, SUBSEQUENT STANDARDS ADOPTED BY REFERENCE THEREIN, AND STANDARD ENGINEERING PRACTICE.

NATHAN G. ROW, P.E. DATE 1/7/2020

SURVEYORS CERTIFICATION

I CERTIFY THAT THE LOCATIONS, ELEVATIONS, DEPTHS, AND AS-BUILT COMMENTS REFLECTING MATERIALS ACTUALLY USED DURING CONSTRUCTION ACCURATELY REFLECT EXISTING FIELD CONDITIONS AS DETERMINED BY ME OR UNDER MY DIRECT SUPERVISION ON THIS DATE: SEPTEMBER-DECEMBER 2019.

JEREMY DISCH, PLS DATE 1-7-2020

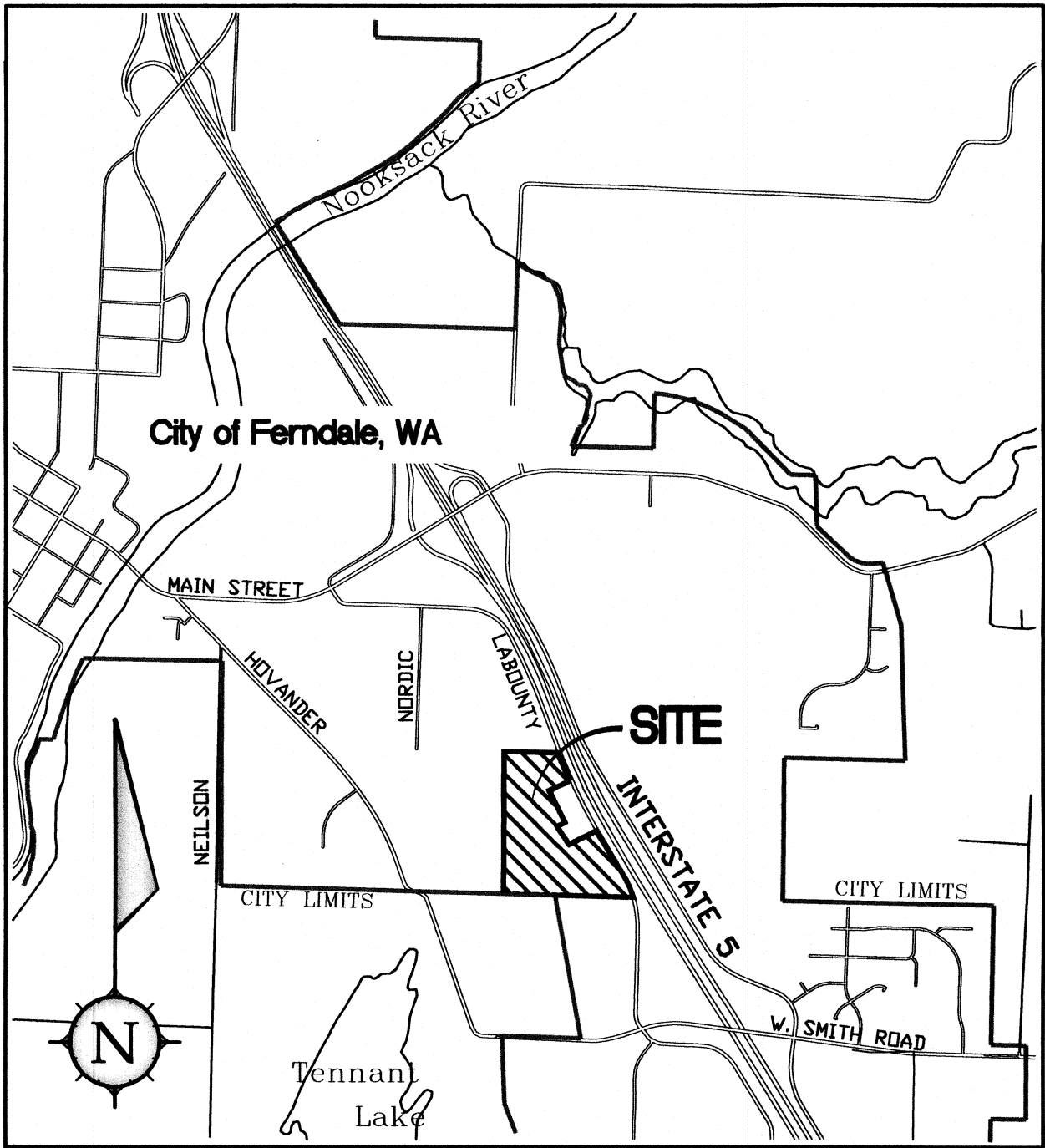

VICINITY MAP

1" = 1500'

MAP NOTES	
BASIS OF ELEVATION/PROJECT BENCHMARK:	CITY OF FERNDALE (83/91) BEARING N43°14'31"E BETWEEN FERN 12 (C.O.F) AND FERN 360
VERTICAL DATUM:	CITY OF FERNDALE (NGVD 29)
SOURCE OF BOUNDARY:	FERN12 - SURFACE MONUMENT ELEV: 31.27
SOURCE OF CONTOURS:	TOPOGRAPHIC SURVEY FROM WILSON SURVEY/ENGINEERING
CONTOUR INTERVAL:	1' CONTOURS CONTOURS ACCURATE TO ONE HALF THE CONTOUR INTERVAL UNLESS OTHERWISE NOTED.
SOURCE AND ACCURACY OF UTILITY INFORMATION:	EXISTING UTILITIES ARE SHOWN BASED ON UTILITY COMPANY PAINTED LOCATION MARKS AND CITY RECORD DRAWINGS, AND MAY NOT REPRESENT ALL UNDERGROUND OR ABOVE-GROUND UTILITIES OR SITE FEATURES. ALL EXISTING UTILITY LOCATIONS SHOWN ARE APPROXIMATE; THE LOCATION AND DEPTH OF ALL UNDERGROUND UTILITIES SHALL BE FIELD VERIFIED BY THE CONTRACTOR.
SCOPE OF WORK:	THE SCOPE OF WORK FOR PREPARATION OF THIS MAP AND ALL EXISTING AND PROPOSED FEATURES IS LIMITED IN THE EXTENT OF FIELD INVESTIGATIONS OF ABOVE AND BELOW GROUND FEATURES AND/OR UTILITIES, AND RELIES ON THE WORK OF OTHERS, INCLUDING SURVEYS, MAPS, RECORD DRAWINGS, AND OTHER INFORMATION SOURCES AS NOTED HEREON.

PROPERTY LEGAL DESCRIPTION:

PARCEL A:
LOT A, "AMENDMENT TO SOUTH-FREWAY SHORT PLAT," RECORDED IN VOLUME 31 OF SHORT PLATS, PAGE 64, UNDER WHATCOM COUNTY AUDITOR'S FILE NO. 941230111, RECORDS OF WHATCOM COUNTY, WASHINGTON, BEING A PORTION OF THE NORTHWEST QUARTER OF THE SOUTHWEST QUARTER OF SECTION 28, TOWNSHIP 39 NORTH, RANGE 2 EAST OF W.M.

SITUATE IN WHATCOM COUNTY, WASHINGTON.

PARCEL A-1:
A NON-EXCLUSIVE EASEMENT OF INGRESS, EGRESS AND UTILITIES AS DELINEATED IN INSTRUMENT RECORDED SEPTEMBER 16, 1998 UNDER AUDITOR'S FILE NO. 1980901997.

PARCEL B:
LOT D, OF SOUTH FREEWAY SHORT PLAT, RECORDED IN BOOK 11 OF SHORT PLATS, PAGE 63, UNDER AUDITOR'S FILE NO. 1498967, RECORDS OF WHATCOM COUNTY, WASHINGTON.

SHEET INDEX

- COVER SHEET AND GENERAL NOTES
- SWPPP AND T.E.S.C.P.
- POND PLAN
- POND DETAILS
- POND DETAILS
- LABOUNTY ROAD FRONTAGE IMPROVEMENTS
- FRONTAGE IMPROVEMENT DETAILS
- PROPOSED ACCESS ROAD SITE PLAN
- PROPOSED ACCESS ROAD PLAN AND PROFILE
- PROPOSED ACCESS ROAD PLAN AND PROFILE

RECORD DRAWING NOTE:
INFORMATION VERIFIED BY SURVEYOR/INSPECTORS MARKED "ASB." RECORD DRAWINGS PREPARED TO INCORPORATE AVAILABLE INFORMATION FROM AS-BUILT SURVEY/CONTRACTOR AS-BUILT/INSPECTOR COMMENTS

AS-BUILT - RECORD DRAWINGS
JANUARY 2020

APPROVED
JAN 08 2020

BY
CITY OF FERNDALE
PUBLIC WORKS DEPARTMENT

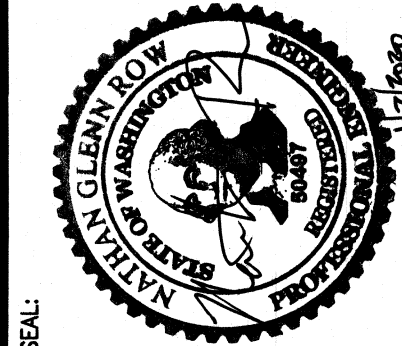

ASSOCIATED PROJECT CONSULTANTS, INC., P.S.
PROFESSIONAL CONSULTING ENGINEERS - LAND USE - CONSTRUCTION AND DEVELOPMENT CONSULTANTS

1401 ASTOR STREET, BELLINGHAM, WA 98225
PHONE (360) 671-1146 FAX (360) 671-1169

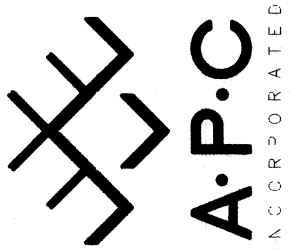

REVISIONS		BY	DATE
NO.	DESCRIPTION		

FABER CONSTRUCTION

PACIFIC FERN BUSINESS PARK

COVER SHEET AND GENERAL NOTES

JOB NO.: 15-107	DESIGNED: NGR	DRAWN: TM	SHEET: 1	OF: 10
-----------------	---------------	-----------	----------	--------

CALL 2 DAYS
BEFORE YOU DIG
1-800-424-5555

CONSTRUCTION STORMWATER POLLUTION PREVENTION PLAN

Element #1 - Mark Clearing Limits

To protect adjacent properties and to reduce the area of soil exposed to construction, the limits of construction will be clearly marked before land-disturbing activities begin. All WORK shall be staked for line and grade in accordance with City of Ferndale Development Standards. In general, natural vegetation and native topsoil adjacent to work areas shall not be disturbed.

Element #2 - Establish Construction Access

Construction access or activities occurring on unpaved areas shall be minimized, yet where necessary, access points shall be stabilized to minimize the tracking of sediment onto public roads, and wheel washing, street sweeping, and street cleaning shall be employed when needed to prevent sediment from entering state waters.

Element #3 - Control Flow Rates

This project is not anticipated to impact downstream flow rates either during or after construction. However, the Contractor shall be responsible for monitoring stormwater runoff in and around the work area during construction, and taking measures as needed to prevent accumulation of runoff as a result of the work that could cause on-site erosion or impact surrounding or downstream properties and drainage conveyances.

Element #4 - Install Sediment Controls

All stormwater runoff from disturbed areas shall pass through an appropriate sediment removal BMP before leaving the construction site or entering a storm drainage conveyance. All existing drainage inlets that could accept runoff from the work area shall be protected with Storm Drain Inlet Protection (BMP C220). Where needed or as directed by the Engineer, Silt Fence (BMP C233) and/or Straw Wattles (BMP C235) may be implemented along the work area.

Sediment will be removed from paved areas in and adjacent to construction work areas manually or using mechanical sweepers, as needed, to minimize tracking of sediments on vehicle tires away from the site and to minimize washoff of sediments from adjacent streets in runoff.

Element #5 - Stabilize Soils

Exposed and unworked soils shall be stabilized with the application of effective BMPs to prevent erosion throughout the life of the project. In general, any slopes will be stabilized as soon as possible and soil stockpiles will be temporarily provided with Plastic Covering (BMP C123). All stockpiled soils shall be stabilized from erosion, protected with sediment trapping measures, and where possible, be located away from storm drain inlets, waterways, and drainage channels.

All disturbed areas along the sanitary sewer route shall be stabilized with Temporary and Permanent Seeding (BMP C120) or Mulching (BMP C121).

Element #6 - Protect Slopes

No cut and fill slopes are anticipated as part of this project.

Element #7 - Protect Drain Inlets

All storm drain inlets and culverts made operable during construction shall be protected to prevent unfiltered or untreated water from entering the drainage conveyance system. However, the first priority is to keep all access roads clean of sediment and keep street wash water separate from entering storm drains until treatment can be provided. Storm Drain Inlet Protection (BMP C220) will be implemented for all drainage inlets and culverts that could potentially be impacted by sediment-laden runoff on and near the project site.

Element #8 - Stabilize Channels and Outlets

Where site runoff is to be conveyed in channels, or discharged to a stream or some other natural drainage point, efforts will be taken to prevent downstream erosion. Where silt-laden runoff is conveyed from the work area in an open conveyance channel or ditch, the Contractor shall install Check Dams (BMP C207) as directed by the Engineer, at a typical spacing of 50-feet O.C.

Element #9 - Control Pollutants

All pollutants, including waste materials and demolition debris, that occur onsite shall be handled and disposed of in a manner that does not cause contamination of stormwater. Good housekeeping and preventative measures will be taken to ensure that the site will be kept clean, well organized, and free of debris. If required, BMPs to be implemented to control specific sources of pollutants are discussed below.

- All vehicles, equipment, and petroleum product storage/dispensing areas will be inspected regularly to detect any leaks or spills, and to identify maintenance needs to prevent leaks or spills.
- On-site fueling tanks and petroleum product storage containers shall include secondary containment.
- Spill prevention measures, such as drip pans, will be used when conducting maintenance and repair of vehicles or equipment.
- In order to perform emergency repairs on site, temporary plastic will be placed beneath and, if raining, over the vehicle.
- Contaminated surfaces shall be cleaned immediately following any discharge or spill incident.
- Any chemicals stored in the construction areas will conform to the appropriate source control BMPs listed in Volume IV of the Ecology stormwater manual. In Western WA, all chemicals shall have cover, containment, and protection provided on site, per BMP C153 for Material Delivery, Storage and Containment.
- Application of agricultural chemicals, including fertilizers and pesticides, shall be conducted in a manner and at application rates that will not result in loss of chemical to stormwater runoff. Manufacturers' recommendations for application procedures and rates shall be followed.
- Dust released from demolished sidewalks, buildings, or structures will be controlled using Dust Control measures (BMP C140).
- Storm drain inlets vulnerable to stormwater discharge carrying dust, soil, or debris will be protected using Storm Drain Inlet Protection (BMP C220 as described above for Element 7).
- Process water and slurry resulting from sawcutting and surfacing operations will be prevented from entering the waters of the State by implementing Sawcutting and Surfacing Pollution Prevention measures (BMP C152).
- Process water and slurry resulting from concrete work will be prevented from entering the waters of the State by implementing Concrete Handling measures (BMP C151).

Element #10 - Control Dewatering

All dewatering water from open cut excavation, tunneling, foundation work, trench, or underground vaults shall be discharged into a controlled conveyance system prior to discharge to a sediment trap or sediment pond. Channels will be stabilized, per Element #8. Clean, non-turbid dewatering water will not be routed through stormwater sediment ponds, and will be discharged to systems tributary to the receiving waters of the State in a manner that does not cause erosion, flooding, or a violation of State water quality standards in the receiving water. Highly turbid dewatering water from soils known or suspected to be contaminated, or from use of construction equipment, will require additional monitoring and treatment as required for the specific pollutants based on the receiving waters into which the discharge is occurring. Such monitoring is the responsibility of the contractor.

However, the dewatering of soils known to be free of contamination will trigger BMPs to trap sediment and reduce turbidity. At a minimum, geotextile fabric socks/bags/cells will be used to filter this material. Other BMPs to be used for sediment trapping and turbidity reduction include the following:

- Concrete Handling (BMP C151)
- Use of a sedimentation bag, with outfall to a ditch or swale for small volumes of localized dewatering.

Element #11 - Maintain BMPs

All temporary and permanent erosion and sediment control BMPs shall be maintained and repaired as needed to assure continued performance of their intended function. Maintenance and repair shall be conducted in accordance with each particular BMP's specifications. Visual monitoring of the BMPs will be conducted at least once every calendar week and within 24 hours of any rainfall event that causes a discharge from the site. If the site becomes inactive, and is temporarily stabilized, the inspection frequency will be reduced to once every month.

All temporary erosion and sediment control BMPs shall be removed within 30 days after the final site stabilization is achieved or after the temporary BMPs are no longer needed. Trapped sediment shall be removed or stabilized on site. Disturbed soil resulting from removal of BMPs or vegetation shall be permanently stabilized.

Element #12 - Manage the Project

Project management by the Contractor shall incorporate the key components listed below:

Phasing of Construction

The construction work shall be phased to the extent practicable to limit the length of open trenches and disturbed areas at one time, in order to prevent soil erosion, and, to the maximum extent possible, the transport of sediment from the site during construction.

Revegetation of disturbed areas and maintenance of that vegetation shall be an integral part of the work during each stage of construction, per the Scheduling BMP (C 162).

Inspection and Monitoring

All BMPs shall be inspected, maintained, and repaired as needed to assure continued performance of their intended function. A Certified Erosion and Sediment Control Lead shall be on-site or on-call at all times. Whenever inspection and/or monitoring reveals that the BMPs identified in this SWPPP are inadequate, due to the actual or potential discharge of a significant amount of any pollutant, appropriate BMPs or design changes shall be implemented as soon as possible.

Maintaining an Updated Construction SWPPP

This SWPPP shall be retained on-site or within reasonable access to the site. The SWPPP shall be modified whenever there is a change in the design, construction, operation, or maintenance of the construction site that has, or could have, a significant effect on the discharge of pollutants to waters of the state.

SEEDING SPECIFICATIONS:

EROSION CONTROL SEED MIXTURE:

- 75-80% TALL FESCUE
- 10-15% SEASIDE/COLONIAL BENTGRASS
- 5-10% REDTOP

SEEDING SHALL MEET THE REQUIREMENTS OF THE DEPARTMENT OF ECOLOGY BMP C120 TEMPORARY AND PERMANENT SEEDING.

CONTRACTOR SHALL BE RESPONSIBLE FOR VEGETATION UNTIL IT IS FULLY ESTABLISHED, AS APPROVED BY THE ENGINEER.

EXST. STORMWATER POND TO BE PERMANENTLY FILLED WITH STRUCTURAL MATERIAL TO BE SUITABLE AS A FUTURE BUILDING SITE. REMOVE ALL PIPE, STRUCTURES, AND UNSUITABLE MATERIAL AS NEEDED AND IN ACCORDANCE WITH THE PROJECT GEOTECHNICAL ENGINEER'S RECOMMENDATIONS. STRUCTURAL FILL MATERIAL COMPACTION METHODS AND ALL WORK SHALL BE IN ACCORDANCE WITH A DESIGN REPORT PREPARED BY A QUALIFIED GEOTECHNICAL PROFESSIONAL AND APPROVED BY THE CITY OF FERNDALE

EROSION CONTROL SPECIFICATIONS:

- ALL DISTURBED AREAS OR EXPOSED SOILS SHALL BE COVERED WITH MULCH OR WOOD CHIPS IF SOILS ARE TO REMAIN UNWORKED FOR MORE THAN 2 DAYS, OCTOBER 1 THROUGH APRIL 30, OR 7 DAYS, MAY 1 THROUGH SEPTEMBER 30. UPON COMPLETION OF CONSTRUCTION, ALL DISTURBED AREAS AND CUT/FILL SLOPES ARE TO BE SEED WITH THE FOLLOWING EROSION CONTROL SEED MIXTURE:
75-80% TALL FESCUE
10-15% SEASIDE/COLONIAL BENTGRASS
5-10% REDTOP

CONTRACTOR SHALL BE RESPONSIBLE FOR VEGETATION UNTIL IT IS FULLY ESTABLISHED, AS APPROVED BY THE ENGINEER.

- EXISTING CATCH BASINS ACCEPTING RUNOFF FROM THE SITE AND DRAINAGE INLETS PLACED INTO SERVICE PRIOR TO FULL SITE STABILIZATION SHALL BE PROTECTED WITH CATCH BASIN INSERTS PER THE DETAIL IN THIS TESP.

- ALL SAWCUTTING AND SURFACING SHALL BE PERFORMED IN ACCORDANCE WITH DEPARTMENT OF ECOLOGY BMP C152. SLURRY AND CUTTINGS SHALL BE VACUUMED DURING SAWCUTTING OPERATIONS, SHALL NOT REMAIN ON PERMANENT PAVEMENT OVERNIGHT, SHALL NOT DRAIN TO ANY NATURAL OR CONSTRUCTED DRAINAGE CONVEYANCE, AND SHALL BE DISPOSED OF IN A MANNER THAT DOES NOT VIOLATE GROUNDWATER OR SURFACE WATER QUALITY STANDARDS.

SITE CONDITIONS AND FEATURES SHOWN PER SITE SURVEY AND LAND DISTURBANCE PLANS PREPARED POWERTEK SURVEYING DATED 04/08/2019.

WETLAND DELINEATION BY CANTRELL AND ASSOCIATES, JANUARY 2016.

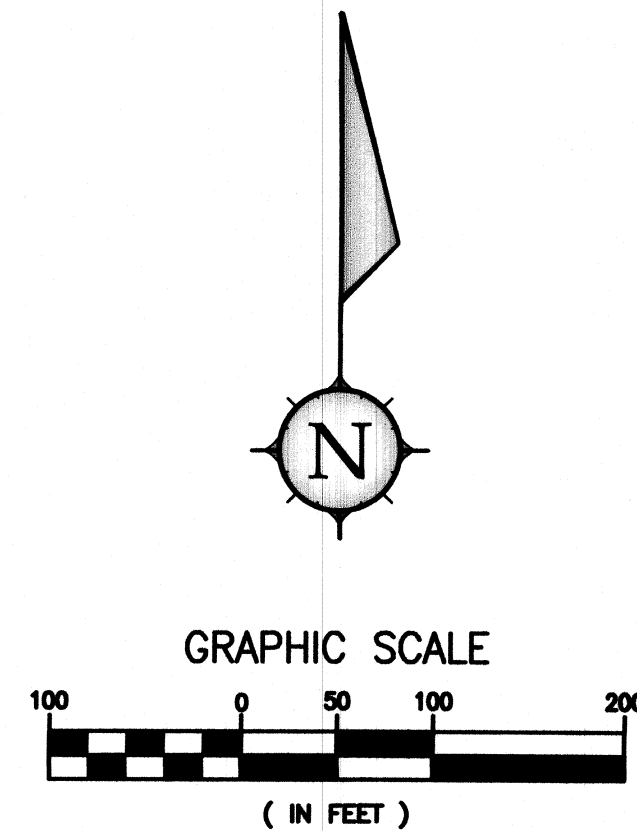

FERN 349
N: 675932.70
E: 1219941.87

FERN 12
N: 673760.11
E: 1222546.51

TEMPORARY EROSION & SEDIMENT CONTROL PLAN

APPROVED

JAN 08 2020

BY: CITY OF FERNDALE
PUBLIC WORKS DEPARTMENT

EROSION CONTROL NOT AS-BUILT

CALL 2 DAYS
BEFORE YOU DIG
1-800-424-5555

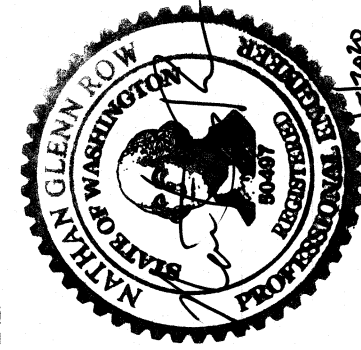

ASSOCIATED PROJECT CONSULTANTS, INC., P.S.
PROFESSIONAL CONSULTING ENGINEERS - LAND USE - CONSTRUCTION AND DEVELOPMENT CONSULTANTS
1401 ASTOR STREET, BELLINGHAM, WA 98225
PHONE (360) 871-1146 FAX (360) 671-1169

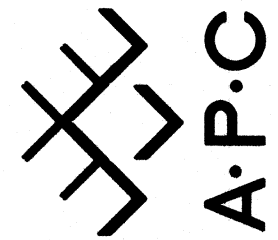

NO.	DATE	REVISIONS		BY
		DESCRIPTION		

FABER CONSTRUCTION

PACIFIC FERN BUSINESS PARK

SWPPP AND T.E.S.C.P.

JOB NO.: 15-107

DESIGNER: NDR

DRAWN: ITM

SHEET: 2

SHEET TITLE: 10

15-107 121519 PACIFIC FERN POND RECORD DRAWING (11/14/20) 15-107 121519 PACIFIC FERN POND RECORD DRAWING (11/14/20) 15-107 121519 PACIFIC FERN POND RECORD DRAWING (11/14/20)

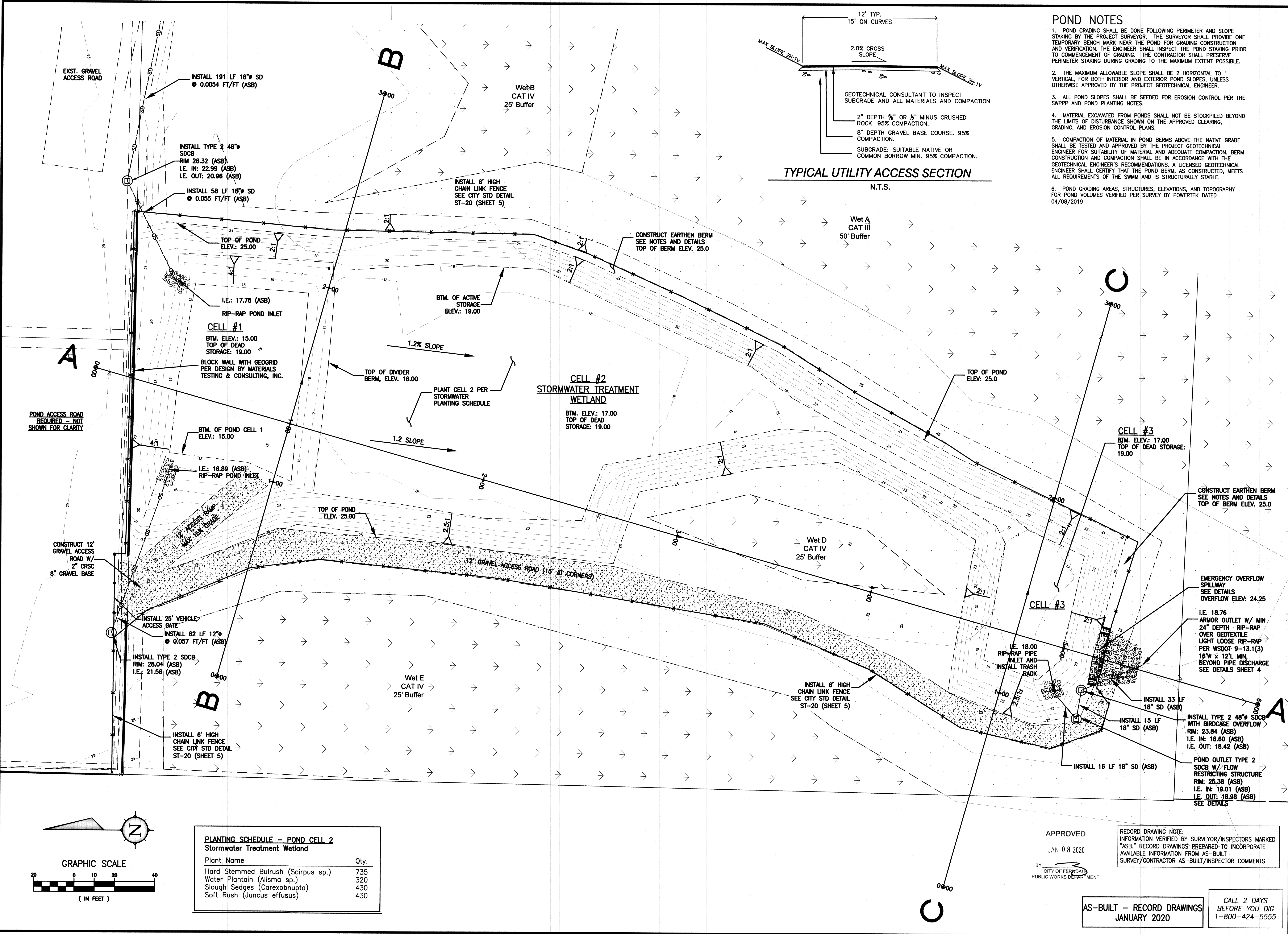

POND NOTES

1. POND GRADING SHALL BE DONE FOLLOWING PERIMETER AND SLOPE STAKING BY THE PROJECT SURVEYOR. THE SURVEYOR SHALL PROVIDE ONE TEMPORARY BENCH MARK NEAR THE POND FOR GRADING CONSTRUCTION AND VERIFICATION. THE ENGINEER SHALL INSPECT THE POND STAKING PRIOR TO COMMENCEMENT OF GRADING. THE CONTRACTOR SHALL PRESERVE PERIMETER STAKING DURING GRADING TO THE MAXIMUM EXTENT POSSIBLE.
2. THE MAXIMUM ALLOWABLE SLOPE SHALL BE 2 HORIZONTAL TO 1 VERTICAL, FOR BOTH INTERIOR AND EXTERIOR POND SLOPES, UNLESS OTHERWISE APPROVED BY THE PROJECT GEOTECHNICAL ENGINEER.
3. ALL POND SLOPES SHALL BE SEEDED FOR EROSION CONTROL PER THE SWPPP AND POND PLANTING NOTES.
4. MATERIAL EXCAVATED FROM PONDS SHALL NOT BE STOCKPILED BEYOND THE LIMITS OF DISTURBANCE SHOWN ON THE APPROVED CLEARING, GRADING, AND EROSION CONTROL PLANS.
5. COMPACTION OF MATERIAL IN POND BERMS ABOVE THE NATIVE GRADE SHALL BE TESTED AND APPROVED BY THE PROJECT GEOTECHNICAL ENGINEER FOR SUITABILITY OF MATERIAL AND ADEQUATE COMPACTION. BERM CONSTRUCTION AND COMPACTION SHALL BE IN ACCORDANCE WITH THE GEOTECHNICAL ENGINEER'S RECOMMENDATIONS. A LICENSED GEOTECHNICAL ENGINEER SHALL CERTIFY THAT THE POND BERM, AS CONSTRUCTED, MEETS ALL REQUIREMENTS OF THE SWMM AND IS STRUCTURALLY STABLE.
6. POND GRADING AREAS, STRUCTURES, ELEVATIONS, AND TOPOGRAPHY FOR POND VOLUMES VERIFIED PER SURVEY BY POWERTEK DATED 04/08/2019

TYPICAL UTILITY ACCESS SECTION

N.T.S.

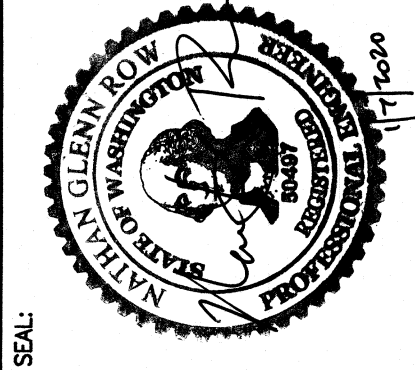

ASSOCIATED PROJECT CONSULTANTS, INC., P.S.
PROFESSIONAL ENGINEERS - LAND USE - CONSTRUCTION AND DEVELOPMENT CONSULTANTS
1401 ASTOR STREET, BELLINGHAM, WA 98225
PHONE (360) 871-1146 FAX (360) 871-1169

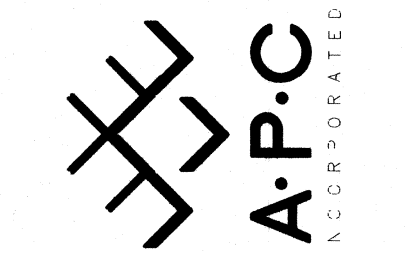

NO.	DATE	REVISIONS	
		DESCRIPTION	BY

FABER CONSTRUCTION
PACIFIC FERN BUSINESS PARK
POND PLAN
SHEET 10 OF 10

APPROVED

JAN 08 2020

BY
CITY OF FERNDALE
PUBLIC WORKS DEPARTMENT

RECORD DRAWING NOTE:
INFORMATION VERIFIED BY SURVEYOR/INSPECTORS MARKED "AS-BUILT". RECORD DRAWINGS PREPARED TO INCORPORATE AVAILABLE INFORMATION FROM AS-BUILT SURVEY/CONTRACTOR AS-BUILT/INSPECTOR COMMENTS

AS-BUILT - RECORD DRAWINGS
JANUARY 2020

CALL 2 DAYS
BEFORE YOU DIG
1-800-424-5555

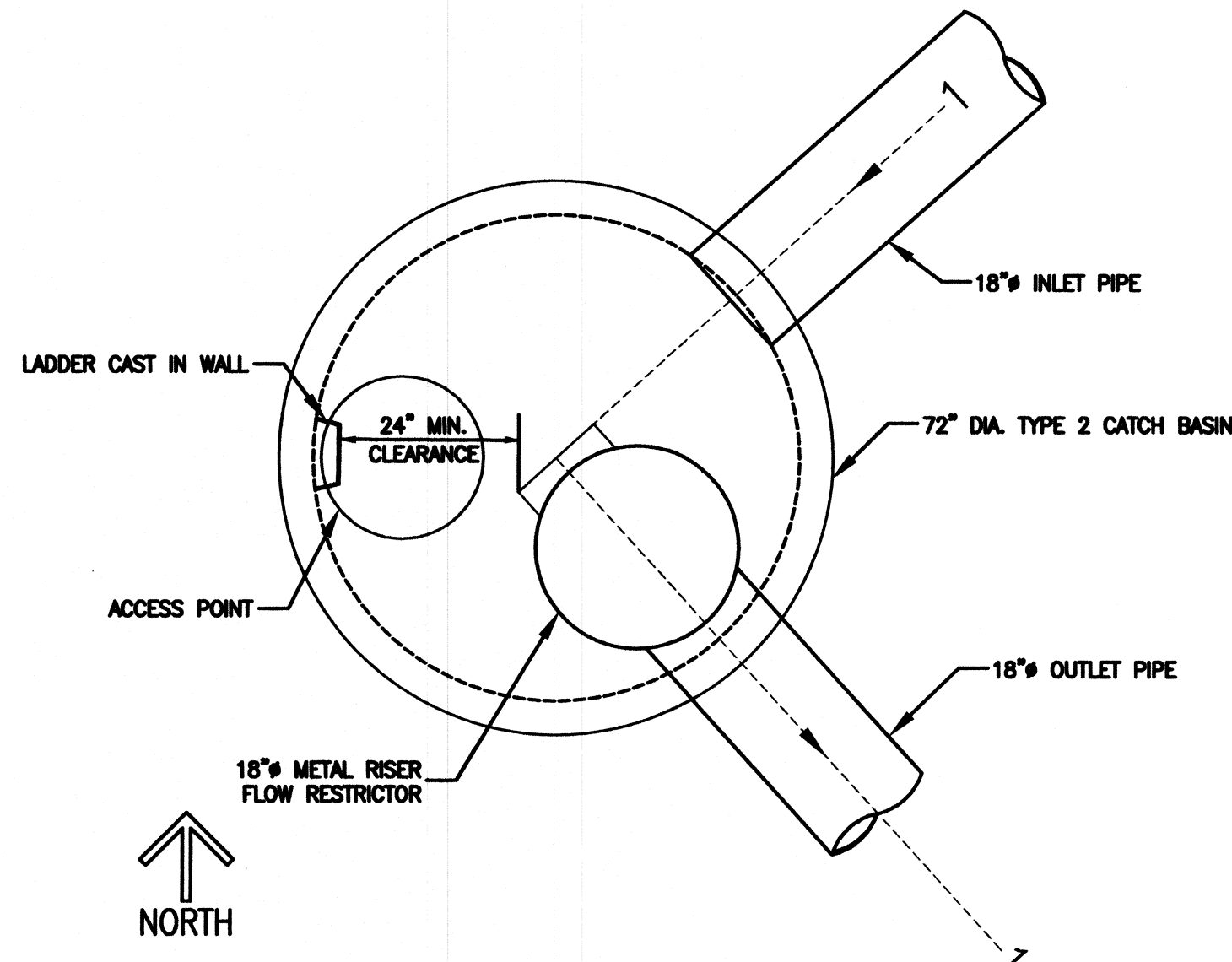

FLOW RESTRICTOR PLAN VIEW
N.T.S.

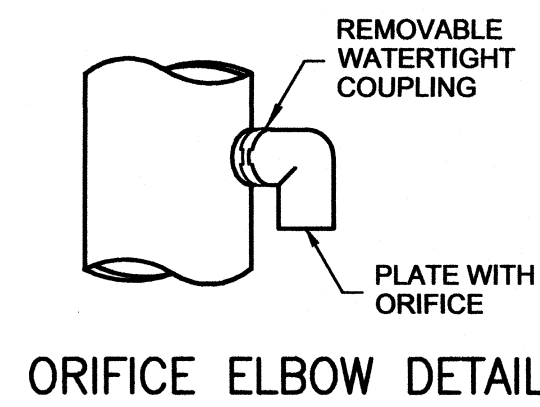

ORIFICE ELBOW DETAIL

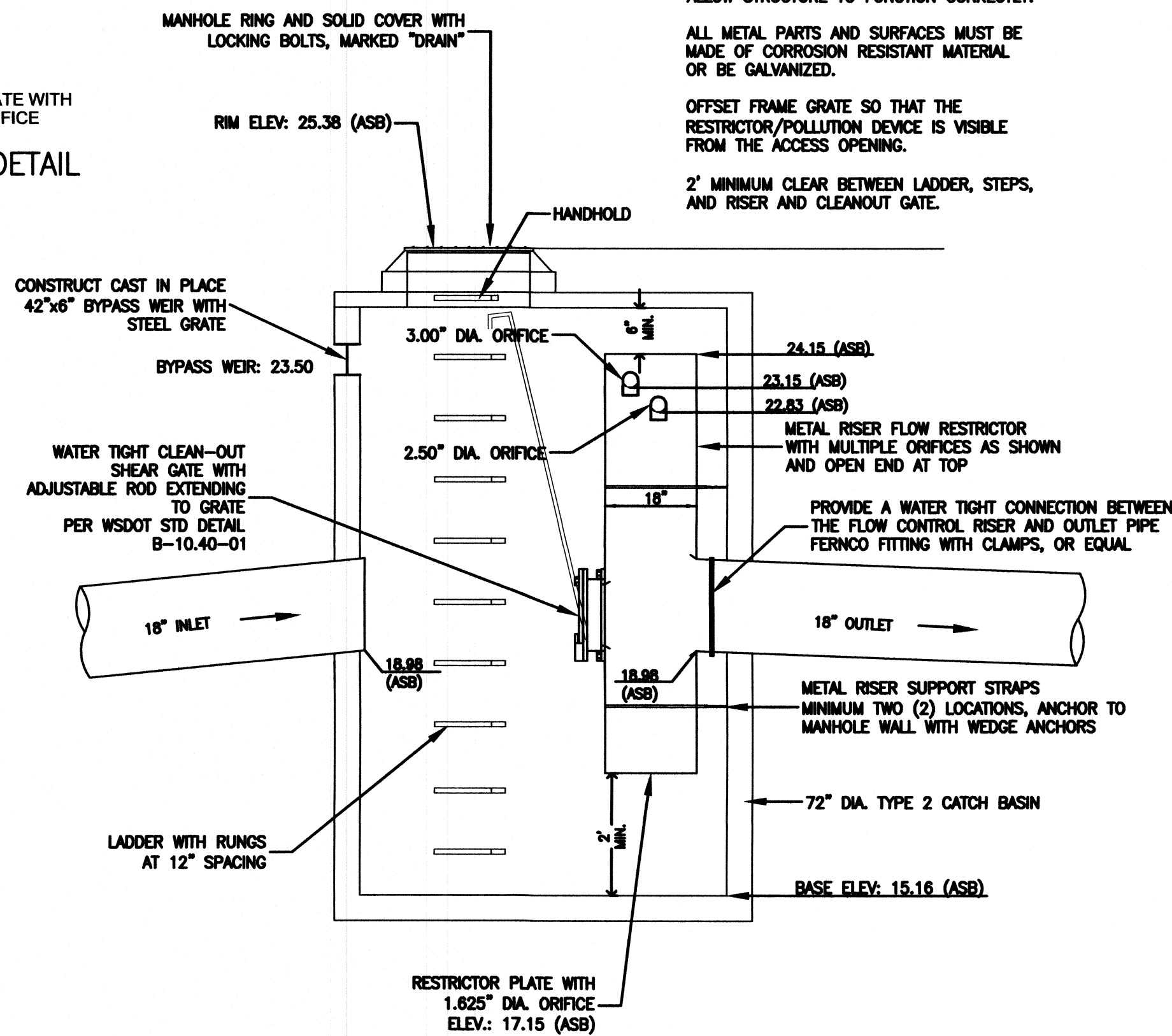

FLOW RESTRICTOR SECTION VIEW
N.T.S.

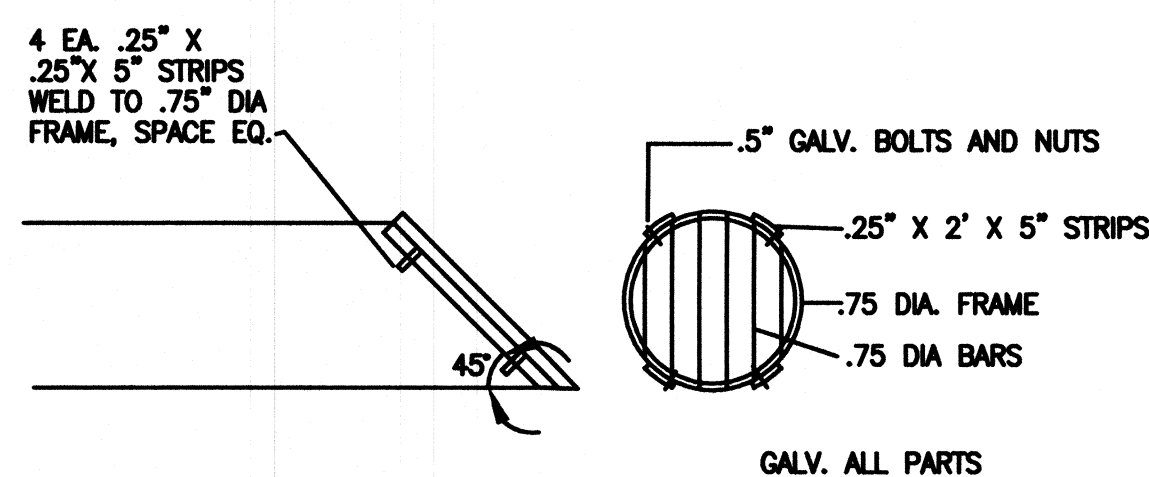

TRASH RACK DETAIL
NOT TO SCALE

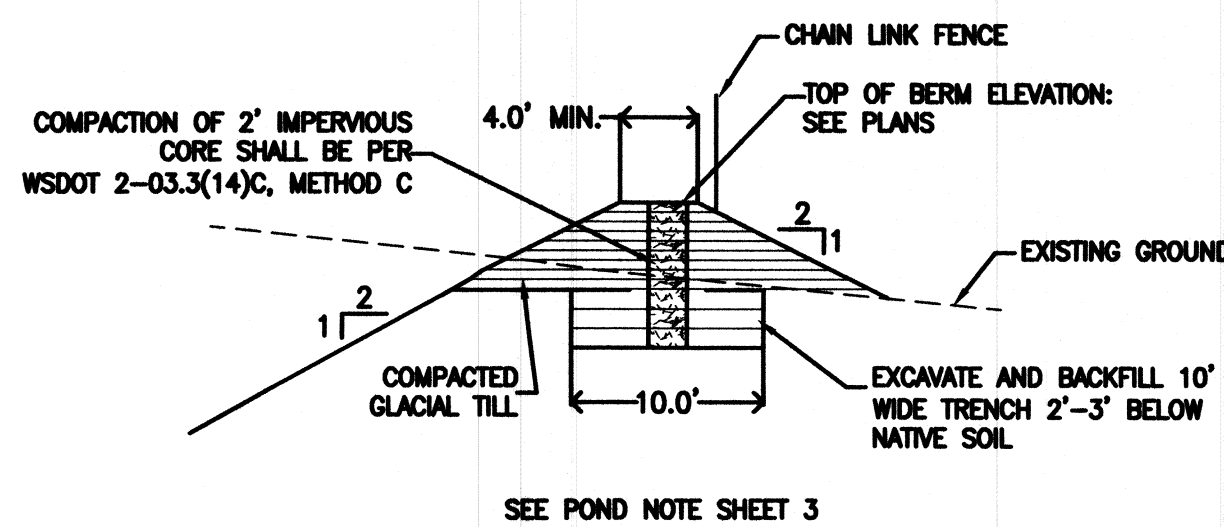

EARTHEN BERM DETAIL
NOT TO SCALE

BLOCK WALL AND GEOGRID SHALL BE IN ACCORDANCE WITH APPROVED DESIGN BY MATERIALS TESTING & CONSULTING, INC. (MTC) AND SHALL BE SUBJECT TO TESTING, INSPECTION, AND DOCUMENTATION OF INSTALLATION AS RECOMMENDED BY MTC IN ACCORDANCE WITH THE APPROVED DESIGN.

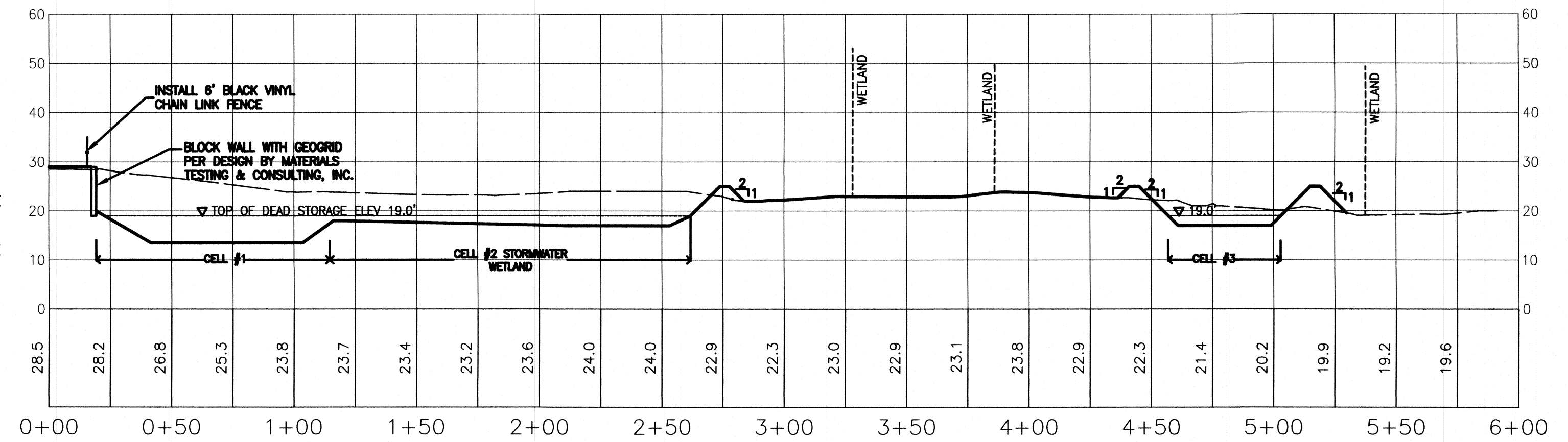

POND SECTION A-A

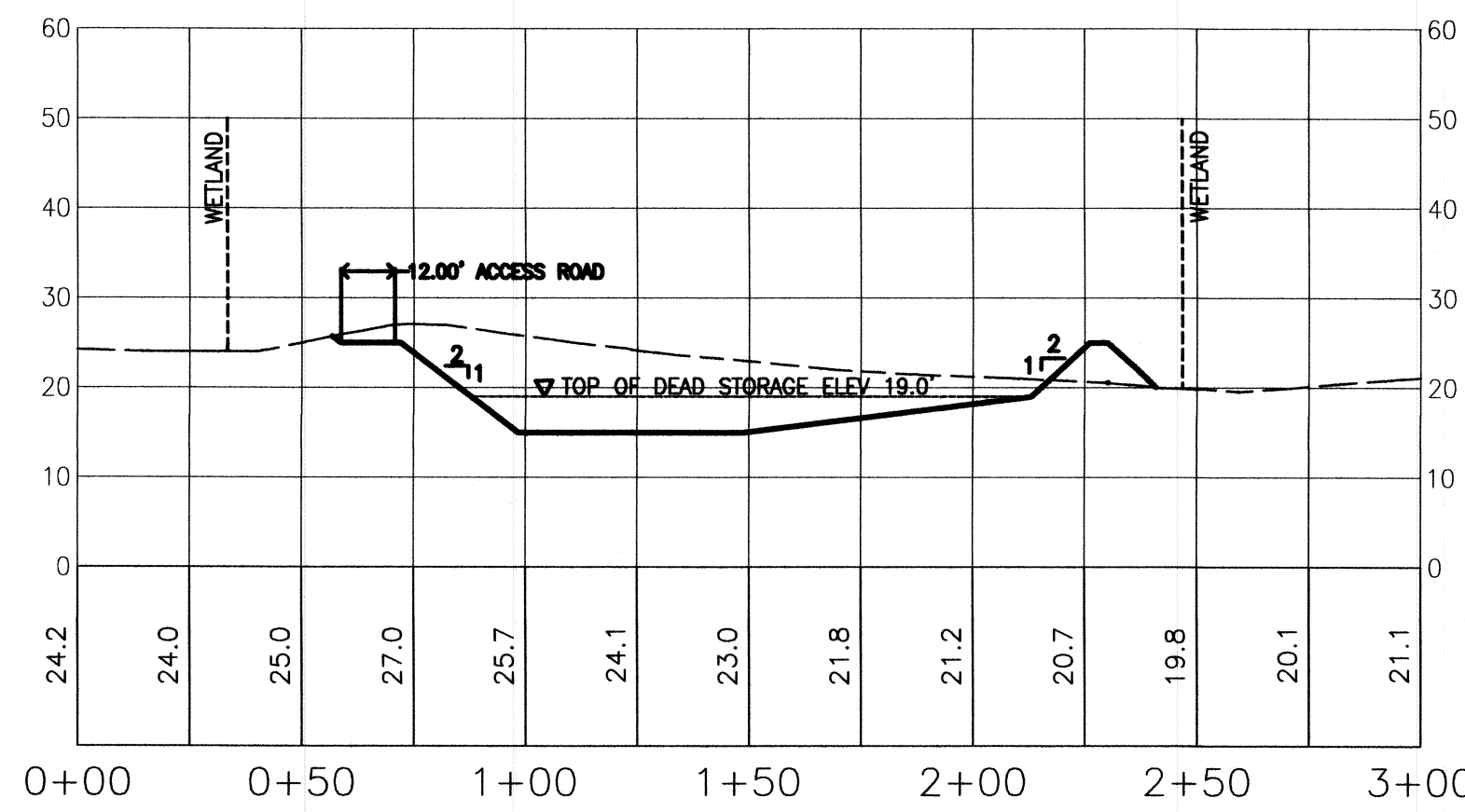

POND SECTION B-B

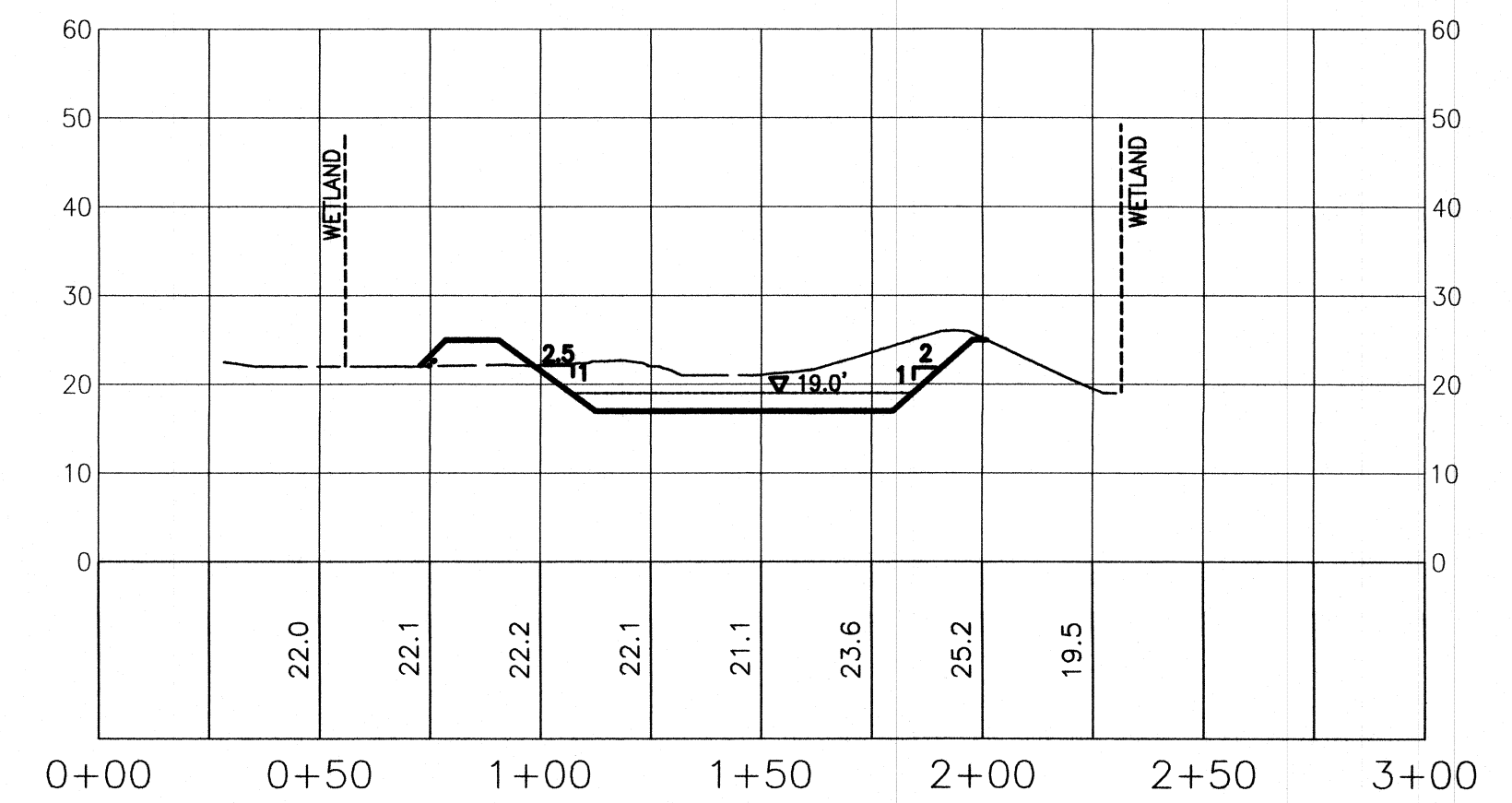

POND SECTION C-C

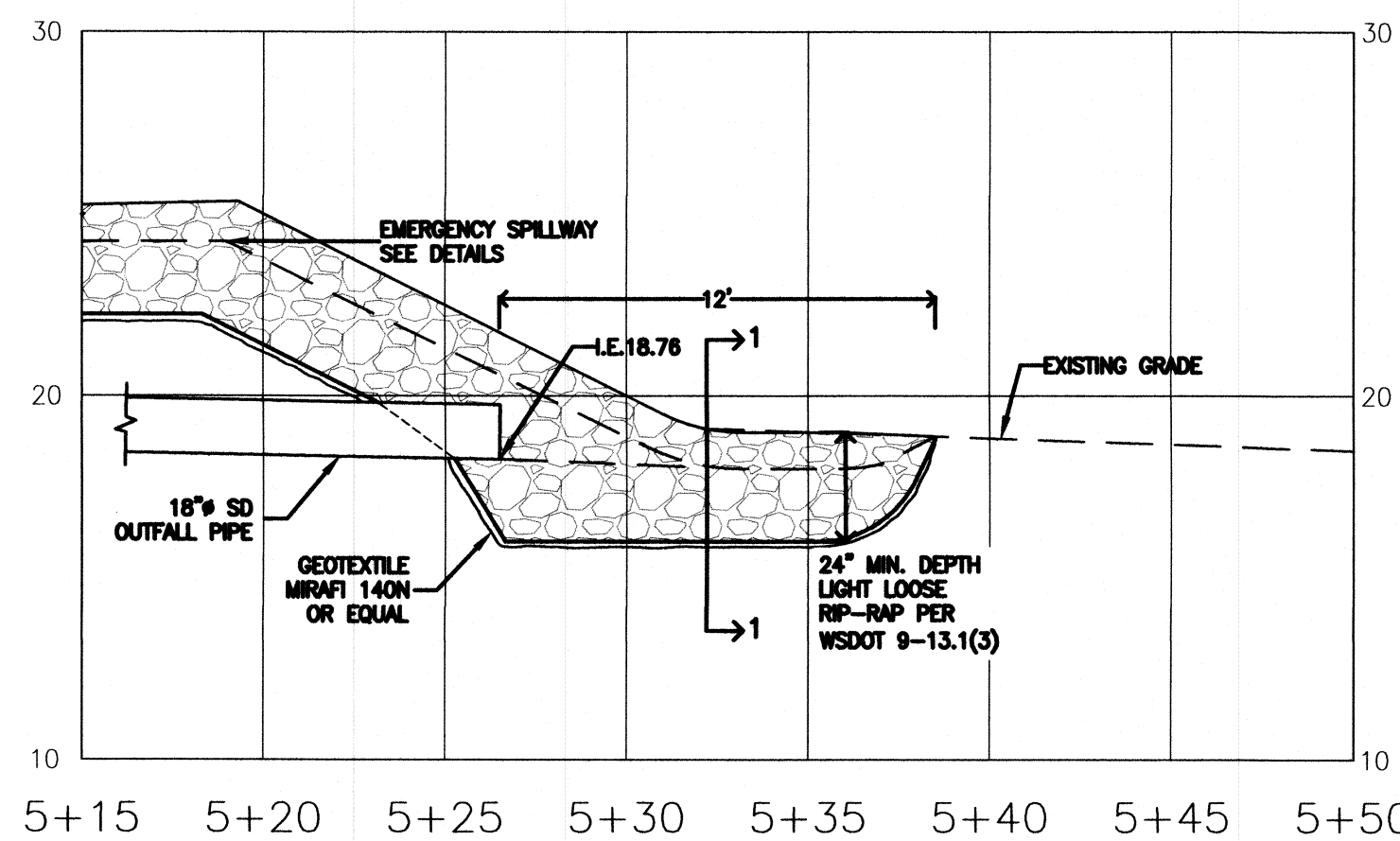

SD OUTFALL PROFILE VIEW
NTS

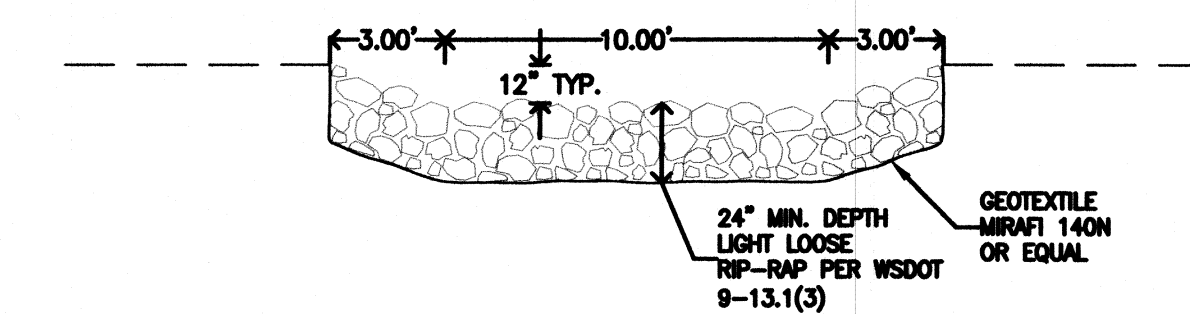

SD OUTFALL SECTION 1-1
NTS

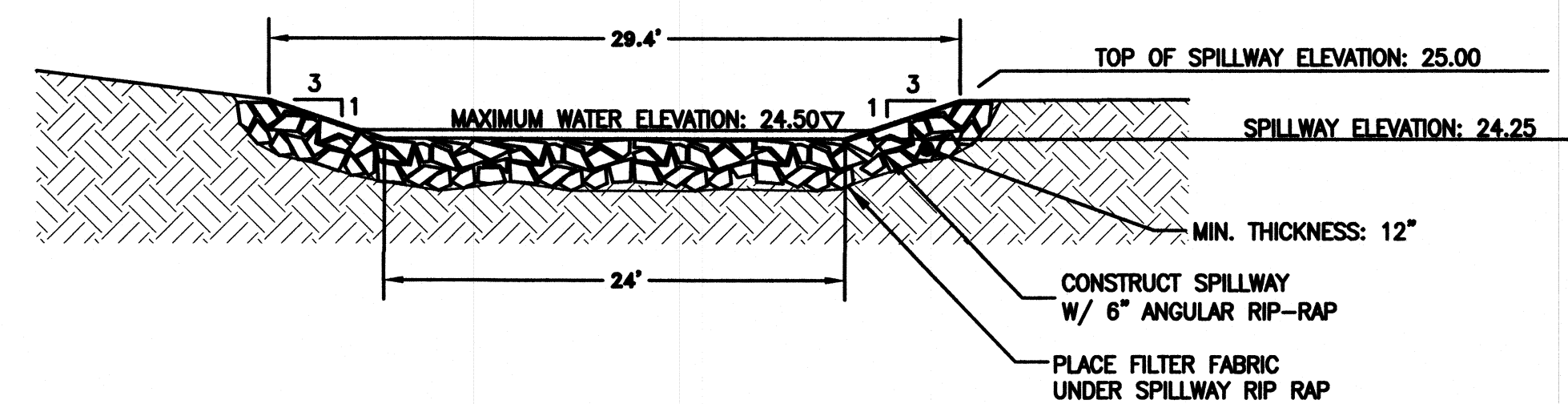

EMERGENCY OVERFLOW SPILLWAY DETAIL
NOT TO SCALE

RECORD DRAWING NOTE:
INFORMATION VERIFIED BY SURVEYOR/INSPECTORS MARKED "ASB." RECORD DRAWINGS PREPARED TO INCORPORATE AVAILABLE INFORMATION FROM AS-BUILT SURVEY/CONTRACTOR AS-BUILT/INSPECTOR COMMENTS

AS-BUILT - RECORD DRAWINGS
JANUARY 2020

CALL 2 DAYS
BEFORE YOU DIG
1-800-424-5555

APPROVED
JAN 08 2020
BY
CITY OF FERNBUSH
PUBLIC WORKS DEPARTMENT

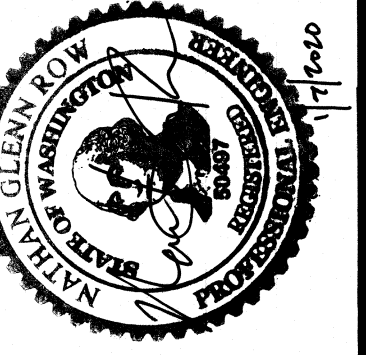

ASSOCIATED PROJECT CONSULTANTS, INC., P.S.
PROFESSIONAL CONSULTING ENGINEERS - LAND USE - CONSTRUCTION AND DEVELOPMENT CONSULTANTS
1401 ASTOR STREET, BELLINGHAM, WA 98225
PHONE (860) 671-1146 FAX (360) 671-1169



NO.	DATE	REVISIONS	DESCRIPTION	BY
1	7/19/18	ADD BLOCK WALL		

CLIENT:	PROJECT:	SHEET TITLE:
15-107	FABER CONSTRUCTION	POND DETAILS
DESIGNED: NFR	DRAWN: TM	OF: 10
SHEET: 4		

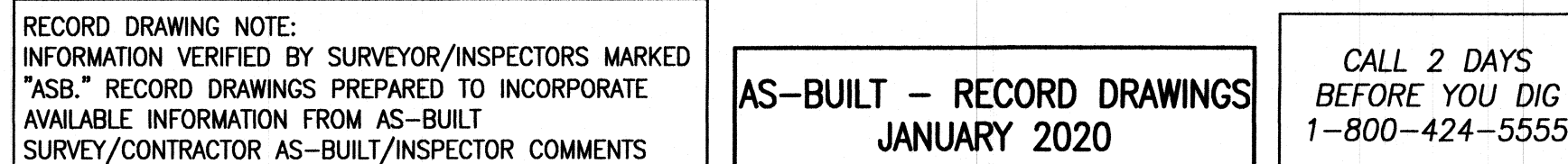
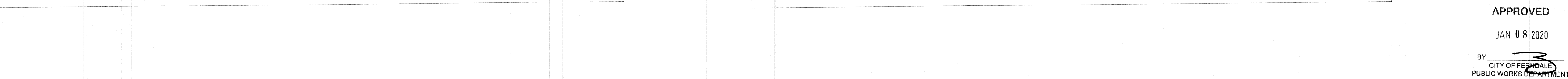

15-107 FRONTAGE IMPROVEMENTS - AS BUILT.dwg

Jan 07, 2020 - 3:28pm

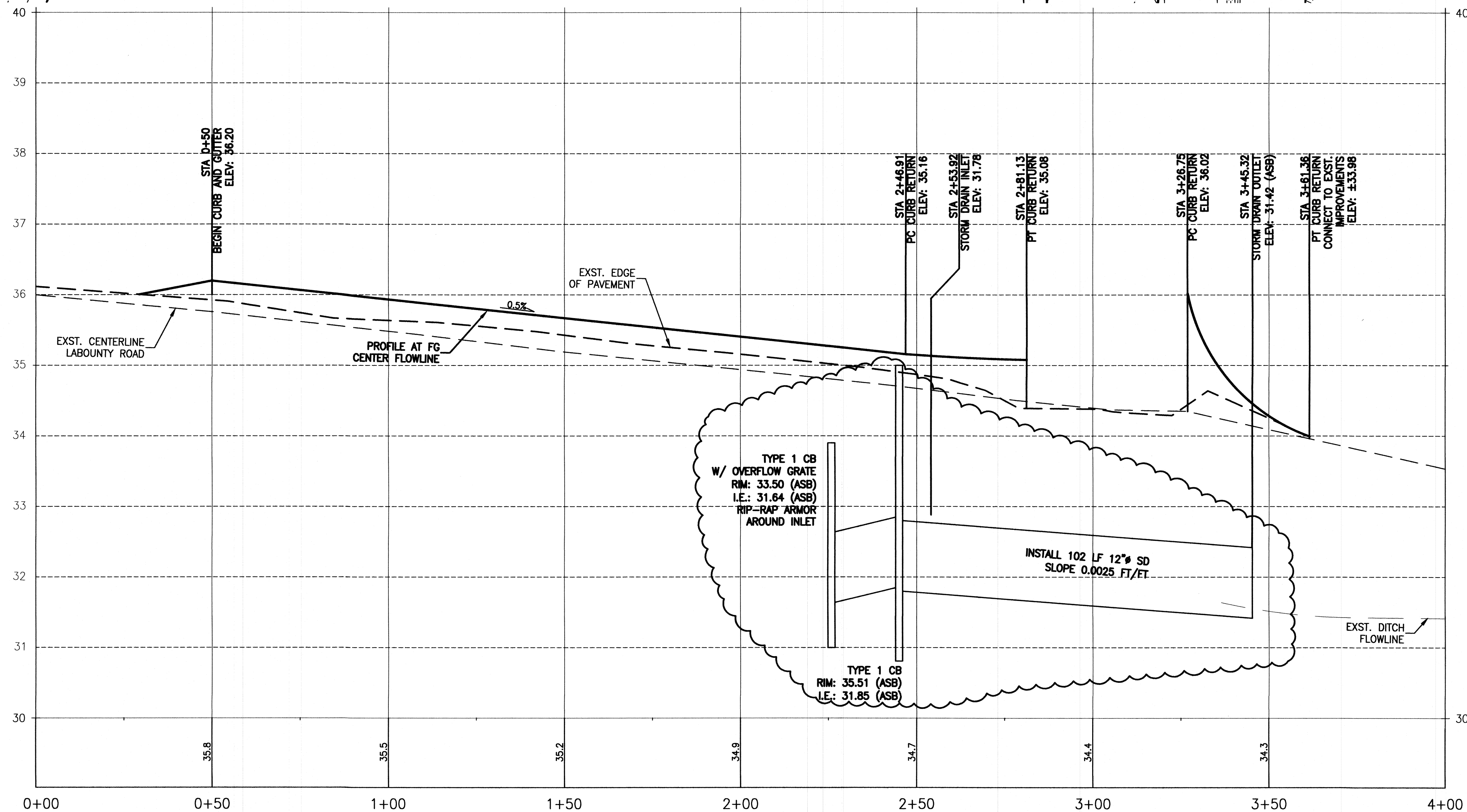
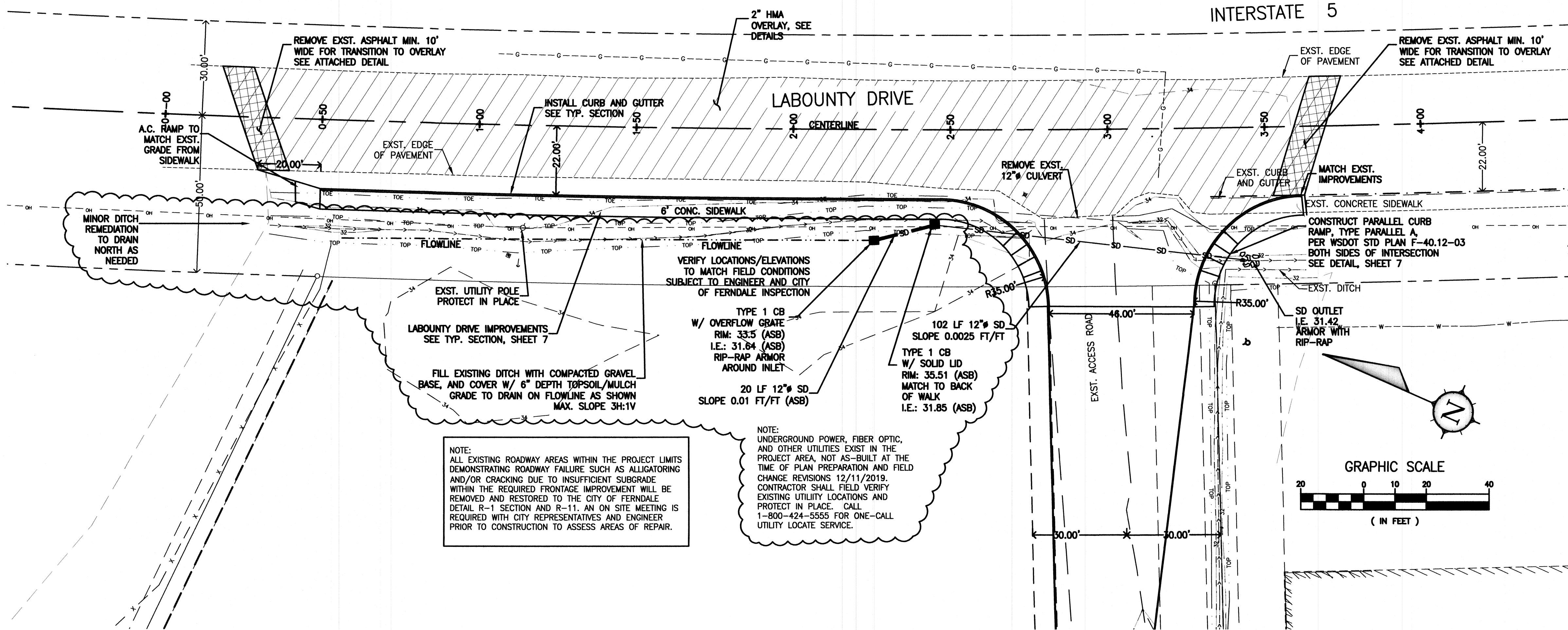

LABOUNTY DRIVE STREET IMPROVEMENT PROFILE

H. SCALE: 1"=20' V. SCALE: 1"=1'

RECORD DRAWING NOTE:
INFORMATION VERIFIED BY SURVEYOR/INSPECTORS MARKED "ASB." RECORD DRAWINGS PREPARED TO INCORPORATE AVAILABLE INFORMATION FROM AS-BUILT SURVEY/CONTRACTOR AS-BUILT/INSPECTOR COMMENTS

AS-BUILT - RECORD DRAWINGS
JANUARY 2020

CALL 2 DAYS
BEFORE YOU DIG
1-800-424-5555

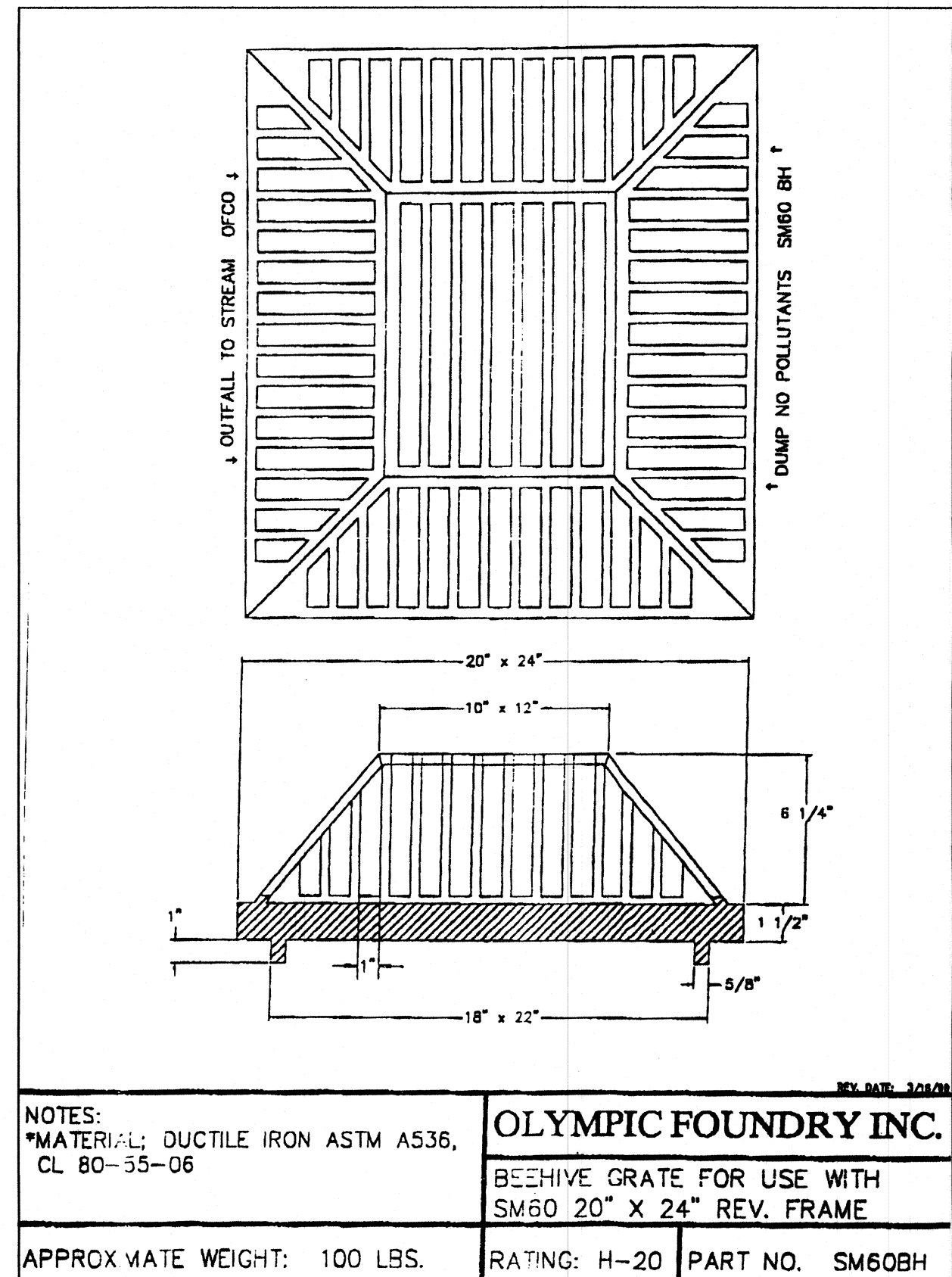

APPROVED
JAN 08 2020
BY
CITY OF FERNDALE
PUBLIC WORKS DEPARTMENT

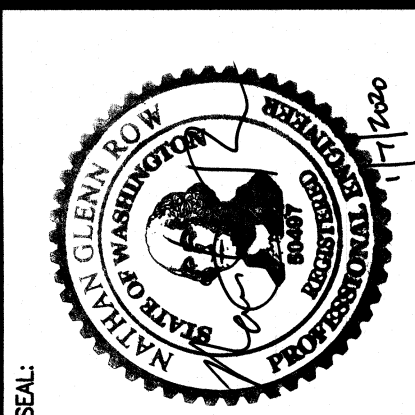

ASSOCIATED PROJECT CONSULTANTS, INC., P.S.
PROFESSIONAL CONSULTING ENGINEERS - LAND USE - CONSTRUCTION AND DEVELOPMENT CONSULTANTS
1401 ASTOR STREET, BELLINGHAM, WA 98225
PHONE (360) 671-1146 FAX (360) 671-1169

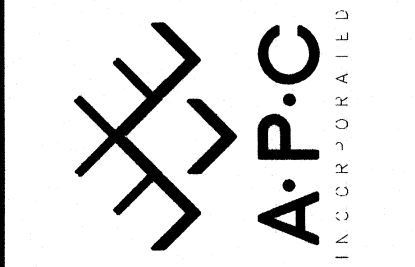

REVISIONS			BY
NO.	DATE	DESCRIPTION	BY
1	06/12/19	UPDATED PLAN AND DETAILS FOR OVERLAY	ITM
2	12/11/19	FIELD CHANGE, REVISION SD GRADING IN DITCHLINE	

CLIENT:		PROJECT:		SHEET TITLE:	
15-107		PACIFIC FERN BUSINESS PARK		LABOUNTY ROAD FRONTAGE IMPROVEMENTS	
DESIGNED: NDR		DRAWN: ITM		OF:	
6		10			

00686.006 1/10/20 KB

Jan 05, 2020 - 11:23am 15-107 FRONTAGE IMPROVEMENTS - AS BUILT.dwg 15-107 FRONTAGE IMPROVEMENTS - AS BUILT.dwg

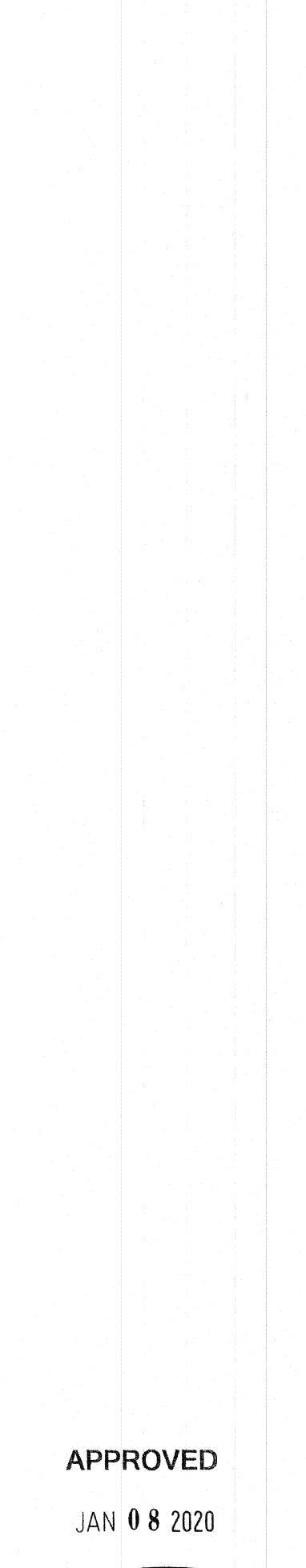
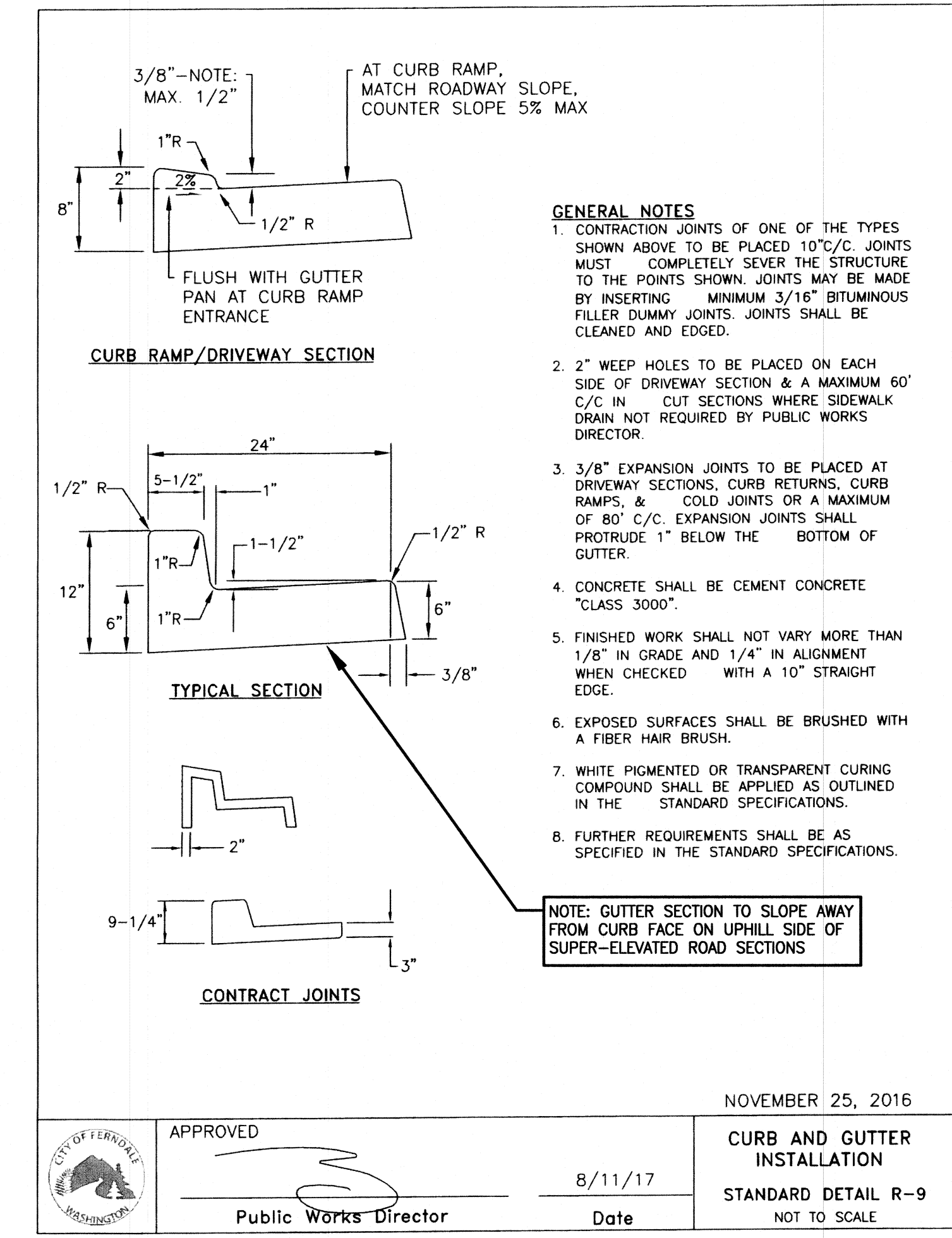
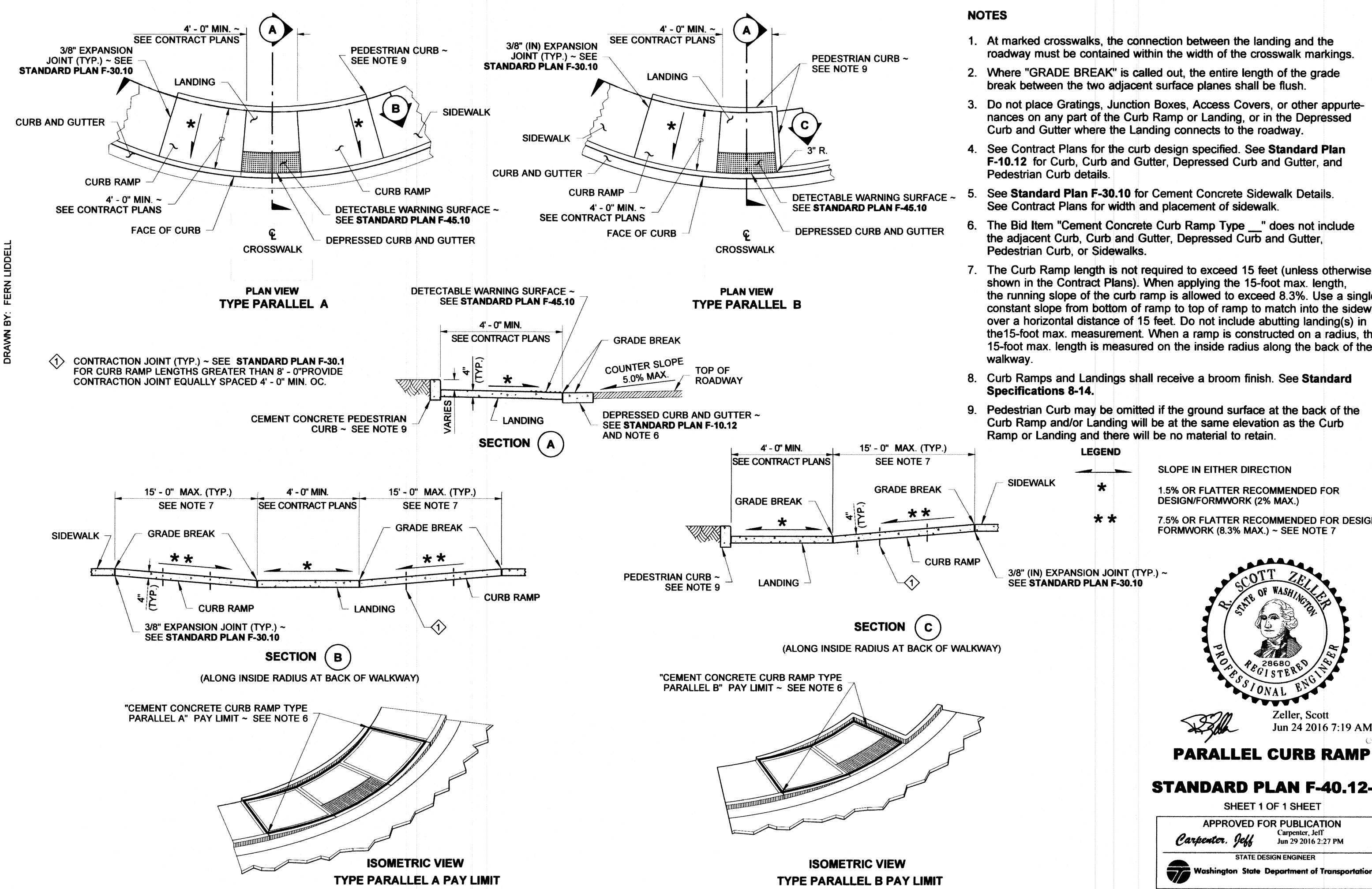
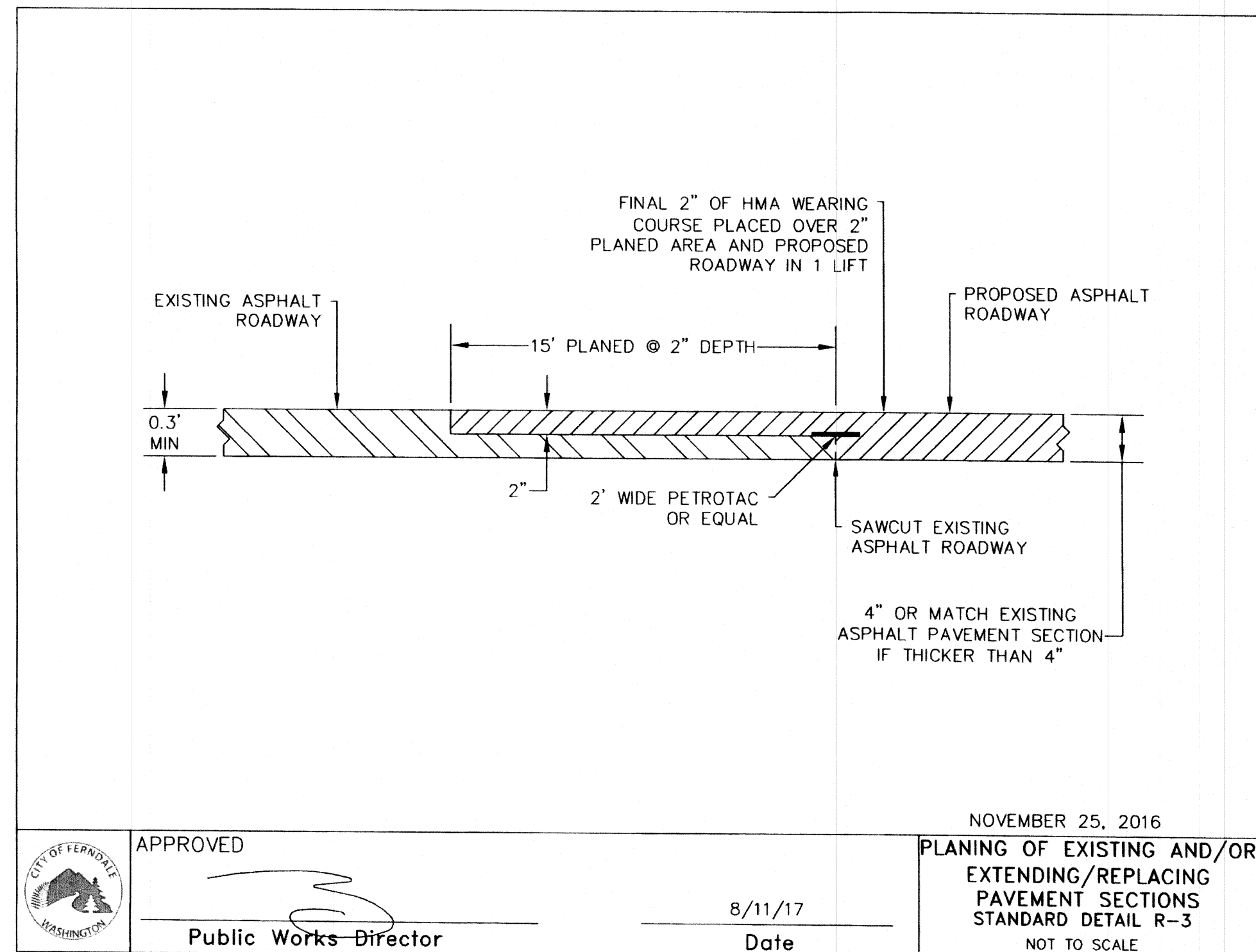
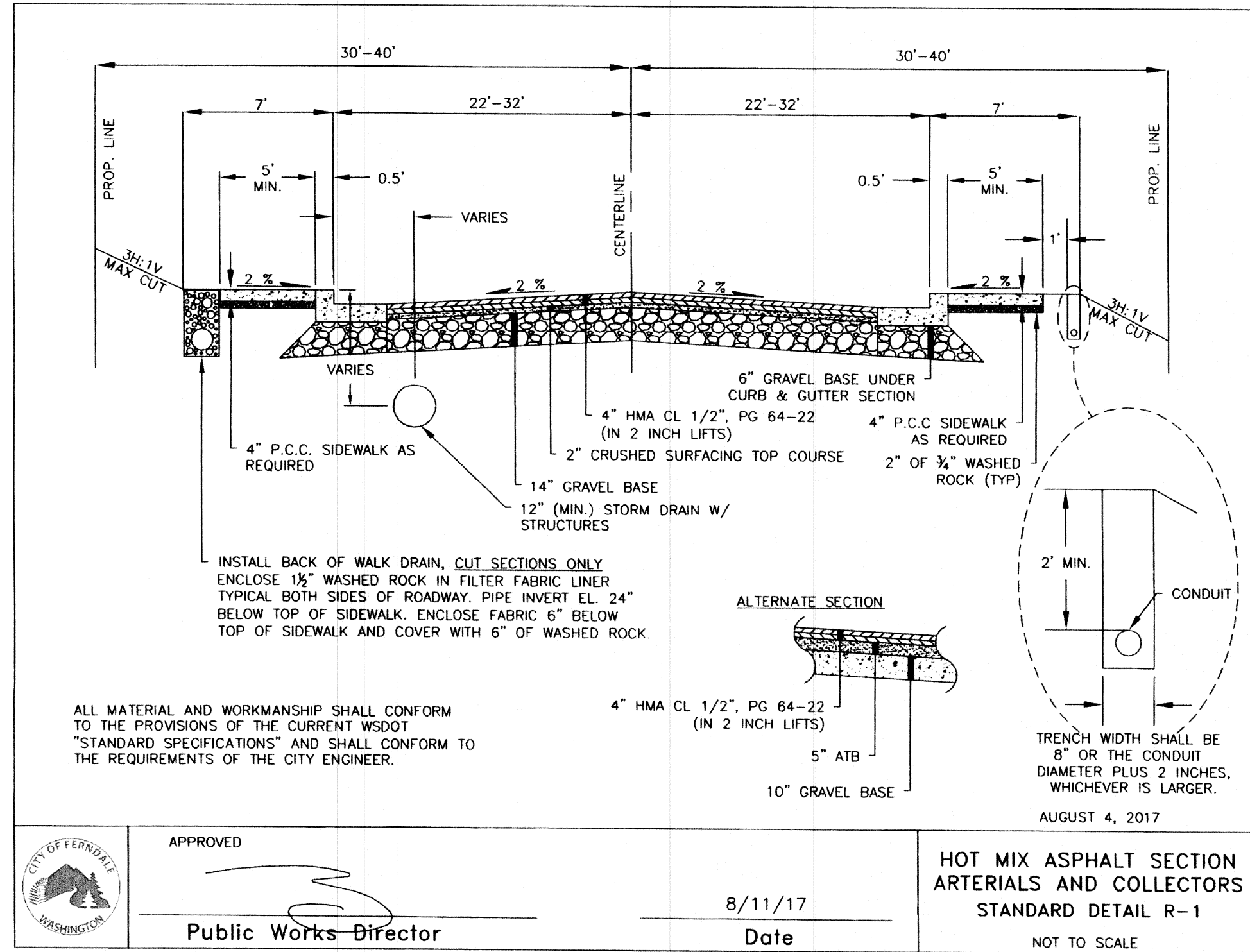
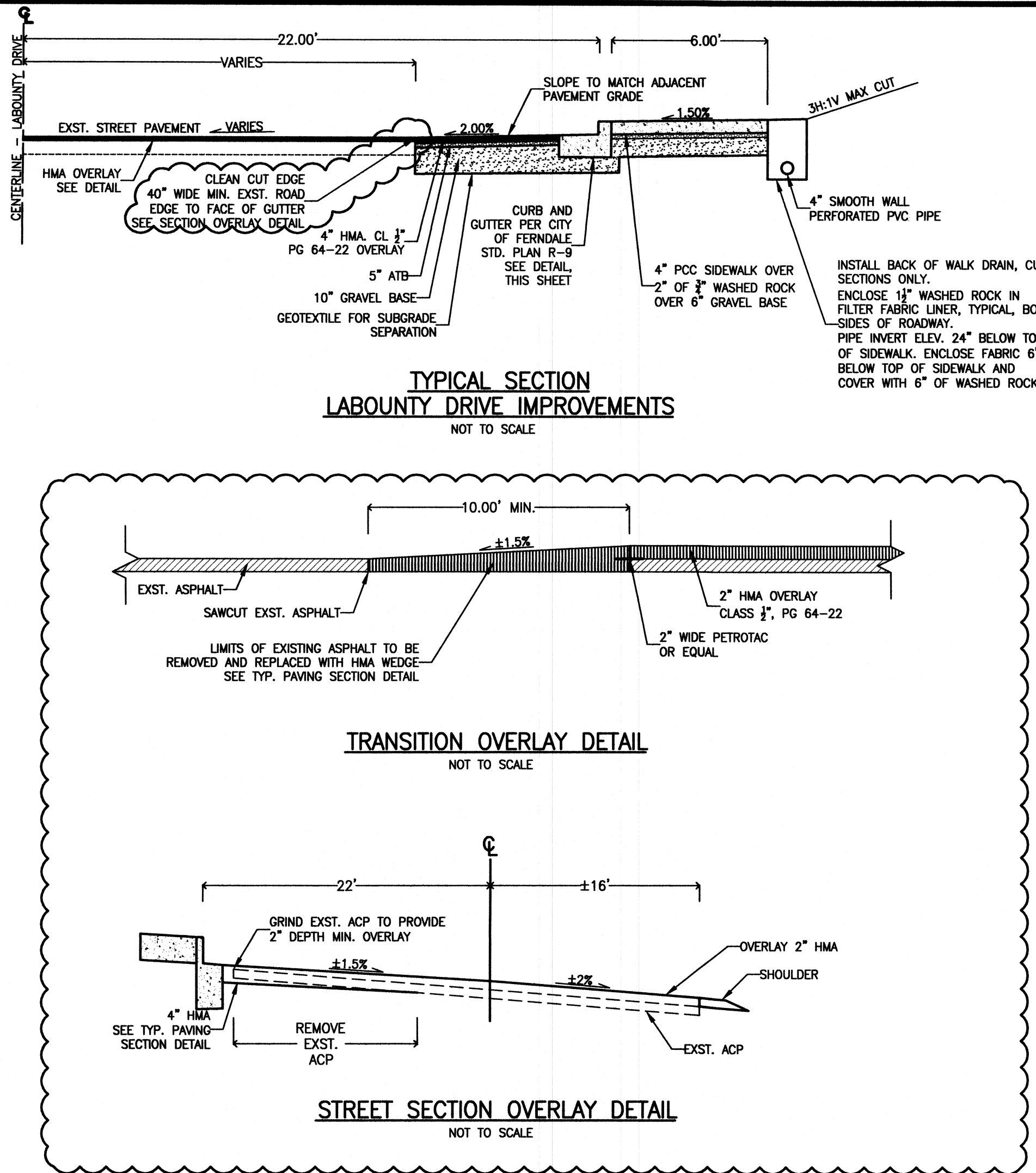

ASSOCIATED PROJECT CONSULTANTS, INC., P.S.
PROFESSIONAL CONSULTING ENGINEERS - LAND USE - CONSTRUCTION AND DEVELOPMENT CONSULTANTS
1401 ASTOR STREET, BELLINGHAM, WA 98225
PHONE (360) 871-1146 FAX (360) 871-1169

A.P.C.
INCORPORATED

FABER CONSTRUCTION
PACIFIC FERN BUSINESS PARK
FRONTAGE IMPROVEMENT DETAILS

REVISIONS

NO.	DATE	DESCRIPTION	BY
1	06/12/19	UPDATED PLAN AND DETAILS FOR OVERLAY	ITM

APPROVED
Public Works Director
Date 8/11/17

APPROVED
Public Works Director
Date 8/11/17

APPROVED
Public Works Director
Date 8/11/17

APPROVED
Public Works Director
Date 8/11/17

RECORD DRAWING NOTE:
INFORMATION VERIFIED BY SURVEYOR/INSPECTORS MARKED "AS-B." RECORD DRAWINGS PREPARED TO INCORPORATE AVAILABLE INFORMATION FROM AS-BUILT SURVEY/CONTRACTOR AS-BUILT/INSPECTOR COMMENTS

AS-BUILT - RECORD DRAWINGS JANUARY 2020

CALL 2 DAYS BEFORE YOU DIG 1-800-424-5555

LAB NO. 15-107
DESIGNED: NDR
DRAWN: ITM
SHEET: 7
OF: 10

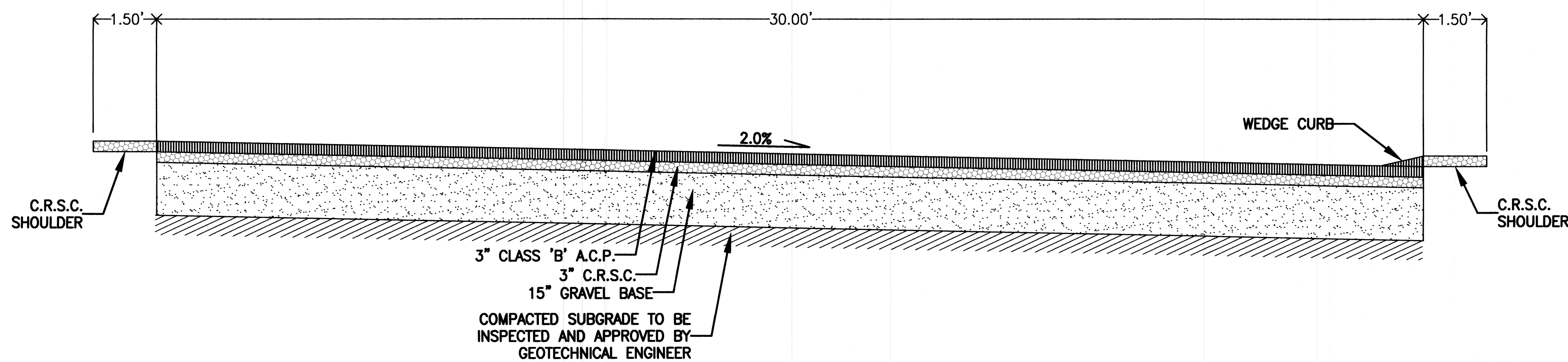
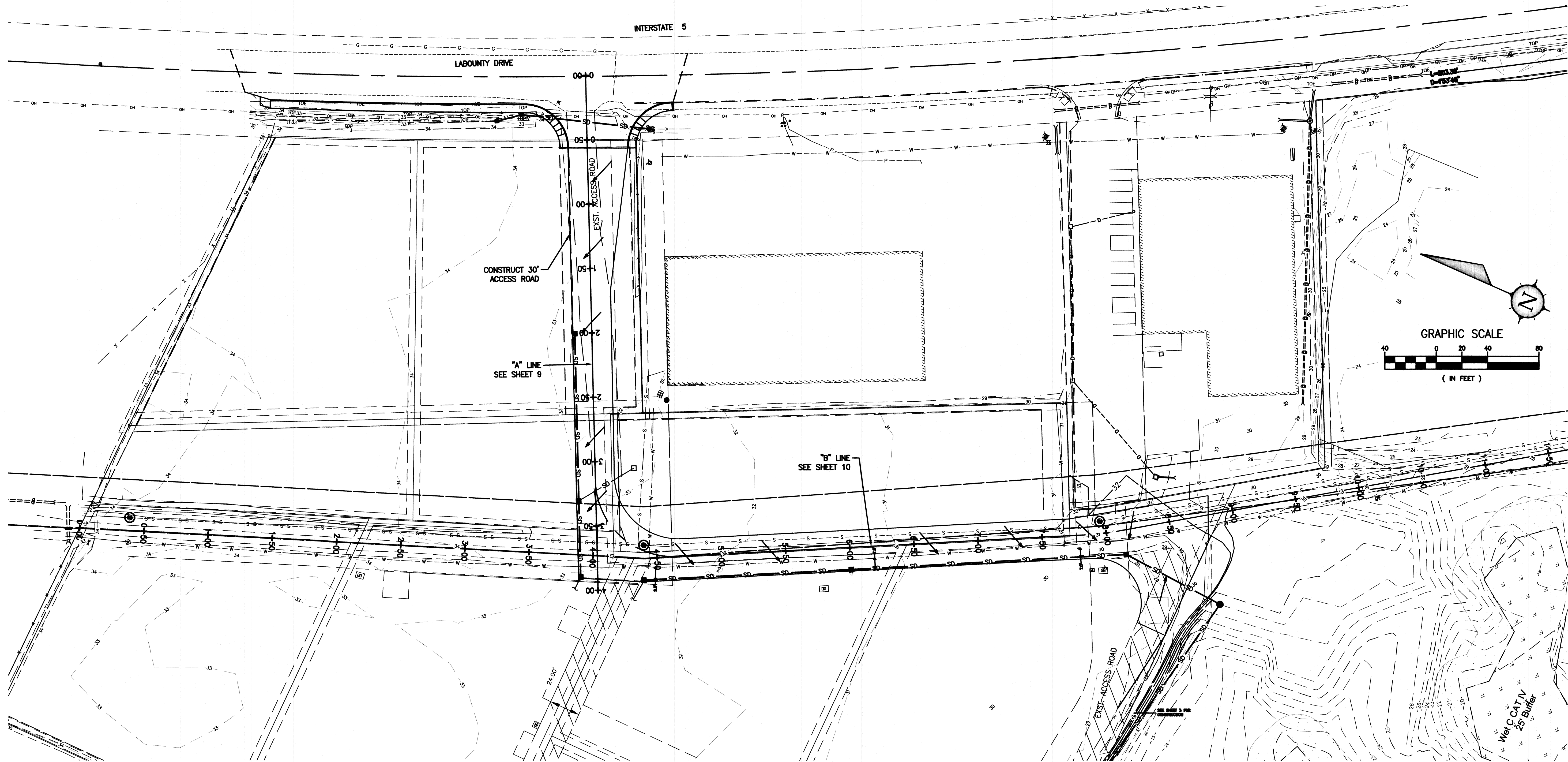

30' PAVED ACCESS ROAD SECTION
N.T.S.

RECORD DRAWING NOTE:
INFORMATION VERIFIED BY SURVEYOR/INSPECTORS MARKED
"AS-B." RECORD DRAWINGS PREPARED TO INCORPORATE
AVAILABLE INFORMATION FROM AS-BUILT
SURVEY/CONTRACTOR AS-BUILT/INSPECTOR COMMENTS

AS-BUILT - RECORD DRAWINGS
JANUARY 2020

CALL 2 DAYS
BEFORE YOU DIG
1-800-424-5555

APPROVED
JAN 08 2020
BY: [Signature]
CITY OF FERN HILLS
PUBLIC WORKS DEPARTMENT

REVISIONS		BY
NO.	DATE	DESCRIPTION

FABER CONSTRUCTION	
PACIFIC FERN BUSINESS PARK	
PROPOSED ACCESS ROAD SITE PLAN	
CLIENT: 15-107	DESIGNED: NDR
DRAWN: TM	SHEET: 8
OF: 10	

ASSOCIATED PROJECT CONSULTANTS, INC., P.S.
PROFESSIONAL CONSULTING ENGINEERS - LAND USE - CONSTRUCTION AND DEVELOPMENT CONSULTANTS
1401 ASTOR STREET, BELLINGHAM, WA 98225
PHONE (360) 871-1146 FAX (360) 871-1169

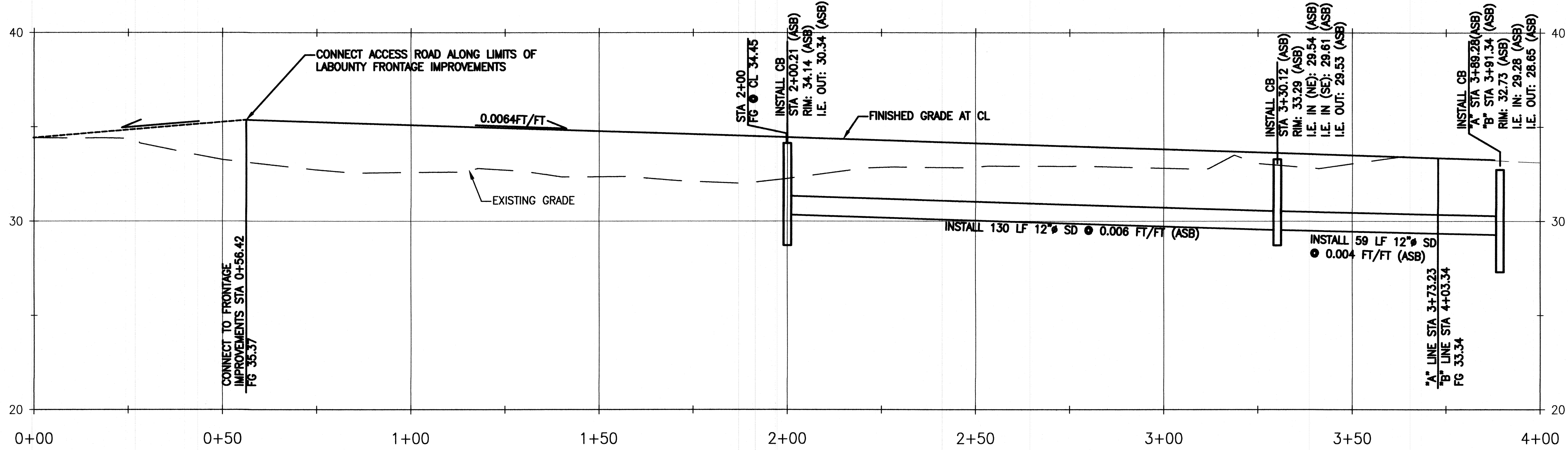
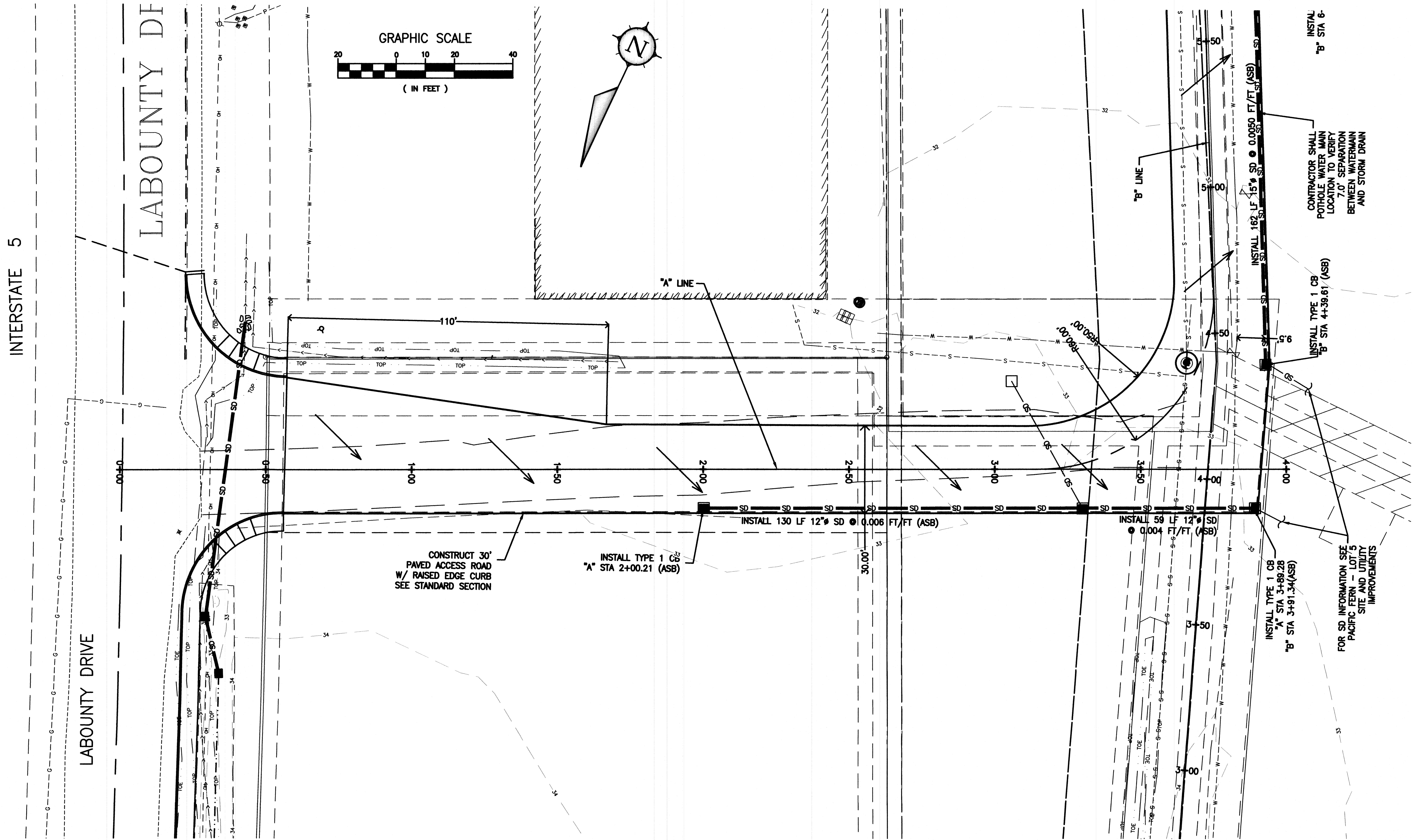

APPROVED
JAN 08 2020
BY
CITY OF FERNDALE
PUBLIC WORKS DEPARTMENT

RECORD DRAWING NOTE:
INFORMATION VERIFIED BY SURVEYOR/INSPECTORS MARKED
"ASB." RECORD DRAWINGS PREPARED TO INCORPORATE
AVAILABLE INFORMATION FROM AS-BUILT
SURVEY/CONTRACTOR AS-BUILT/INSPECTOR COMMENTS

AS-BUILT - RECORD DRAWINGS
JANUARY 2020

CALL 2 DAYS
BEFORE YOU DIG
1-800-424-5555

REVISIONS		BY
NO.	DATE	

FABER CONSTRUCTION	
PACIFIC FERN BUSINESS PARK	
PROPOSED ACCESS ROAD PLAN AND PROFILE	
CLIENT:	15-107
DESIGNED: NFR	ITM
DRAWN:	
SHEET:	9
OF:	10

ASSOCIATED PROJECT CONSULTANTS, INC., P.S.
PROFESSIONAL CONSULTING ENGINEERS - LAND USE - CONSTRUCTION AND DEVELOPMENT CONSULTANTS
1401 ASTOR STREET, BELLINGHAM, WA 98225
PHONE (360) 671-1146 FAX (360) 671-1169

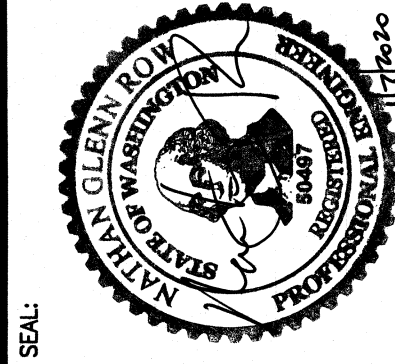
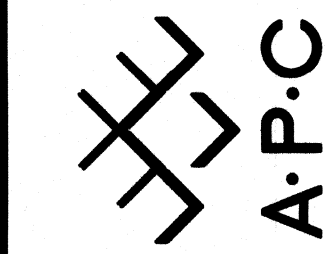

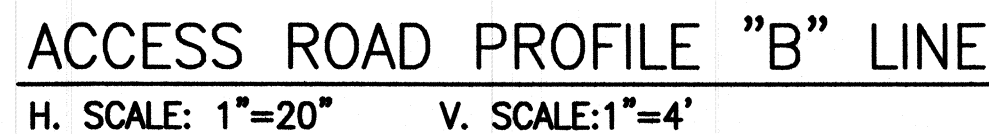
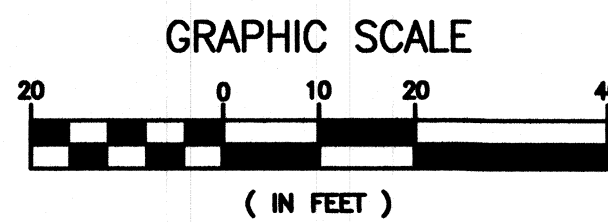

CALL 2 DAYS
BEFORE YOU DIG
1-800-424-5555

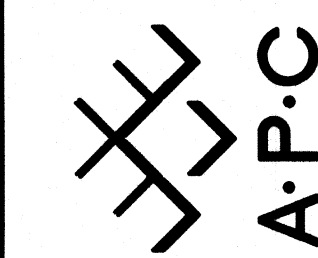

CLIENT:	FABER CONSTRUCTION
PROJECT:	PACIFIC FERN BUSINESS PARK
SHEET TITLE:	PROPOSED ACCESS ROAD PLAN AND PROFILE

JOB NO.: 15-107	DESIGNED: NGR	10	SHEET:
DRAWN: ITM	OF:		